

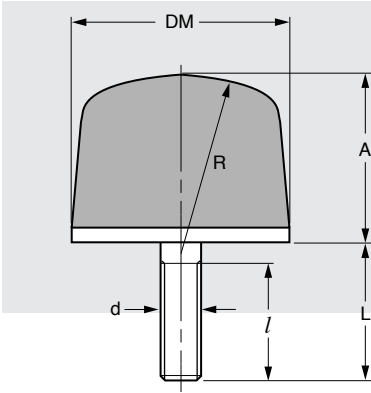

Bumpers – Dome Type

www.vibrationmounts.com Phone: 516.328.3662 Fax: 516.328.3365

- MATERIAL:** Isolator – High Damping Rubber
Plate & Screw – Steel, Zinc Plated



FEATURES:

- Effective in neutralizing large shock loads. It allows soft impact with increasing bending and spring constant which results in the smooth absorption of a large impact force.
- Noise generation prevention; accepts a large load deformation with practically no friction. It does not generate noise at the instant of contact.
- Easy mounting. Simple to attach the unit with no need for maintenance.
- These bumpers feature a specially shock and vibration attenuating compound with high energy absorption characteristics.



Metric

NOTE: Dimensions in () are inch.

Catalog Number	DM	A	L	R	l	d	Max. Stroke	Max. Energy kgf•m (lb.ft.)	Max. Impact Load kgf X 10 ³ (lb. X 10 ³)
V11Z07MR025HD	25 (.98)	25 (.98)	18 (.71)	10 (.39)	16 (.63)	M6	11 (.43)	.9 (6.5)	.28 (.62)
V11Z07MR030HD	30 (1.18)	31 (1.22)	24 (.94)	14 (.55)	20 (.79)	M8	14 (.55)	1.9 (13.7)	.38 (.84)
V11Z07MR045HD	45 (1.77)	36 (1.42)	29 (1.14)	40 (1.58)	25 (.98)		16 (.63)	6.1 (44.1)	1.2 (2.65)
V11Z07MR065HD	65 (2.56)	45 (1.77)	35 (1.38)	50 (1.97)	35 (1.38)	M12	21 (.83)	19 (137.4)	3.3 (7.28)

PERFORMANCE CHART

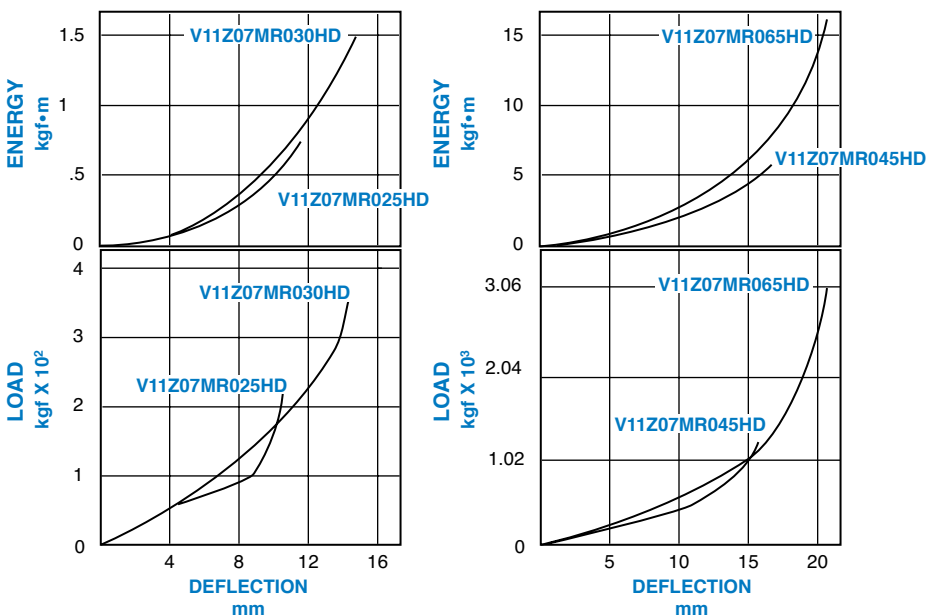

COMPARISON OF NATURAL RUBBER VS. HIGH ATTENUATION HD RUBBER

RESULTS OF DROPPING A STEEL BALL ON TO THE RUBBER MAT

