

# Cylindrical Mounts – Rubber – To 1 lb.

www.vibrationmounts.com Phone: 516.328.3662 Fax: 516.328.3365

• **MATERIAL:** Fasteners – Steel, Zinc Plated  
Isolator – Synthetic Rubber

• **FOR COMPRESSION LOADS OF .5 TO 1 POUNDS (0.23 TO 0.45 kgf)**  
• **FOR SHEAR LOADS OF .2 TO .4 POUNDS (0.09 TO 0.18 kgf)**

Cylindrical Mounts

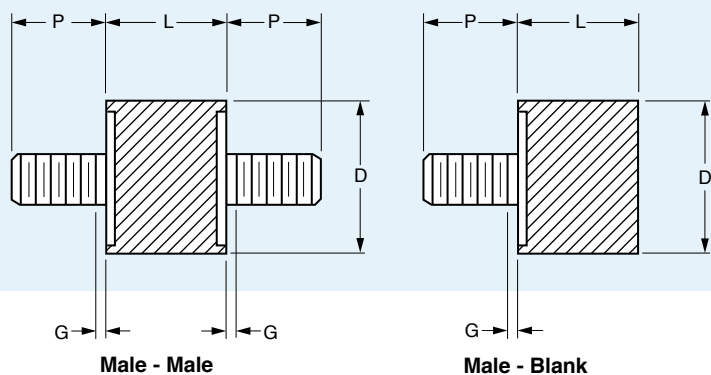

**FEATURES:**

- Highly damped
- Oil resistant

Catalog Number	Durometer	D	L	P	G	Thread Size	Load lb. (kgf)		Stiffness lb./in. (kgf/mm)				Temperature Range	
							Cmpr. Max.	Shear $\Delta$	Static		Dynamic		Peak Performance	Max. Intermittent
									Cmpr.	Shear $\Delta$	Cmpr.	Shear $\Delta$		
V10Z 3-□□1R0420	20	.280 (7.1)	.320 (8.1)	.200 (5.1)	.060 (1.5)	#4-40	.5 (0.23)	.2 (0.09)	40 (0.71)	5 (2.3)	126 (2.3)	12 (0.21)	+40°F to +100°F (+4.4°C to +37.8°C)	+155°F (+68.3°C)
*V10Z 3-□□1R0425	25						.5 (0.23)	.2 (0.09)	55 (0.98)	7 (0.13)	185 (3.3)	15 (0.27)	+40°F to +100°F (+4.4°C to +37.8°C)	+155°F (+68.3°C)
V10Z 3-□□2R0620	20	.405 (10.3)	.500 (12.7)	.375 (9.5)	.060 (1.5)	#6-32	1.0 (0.45)	.4 (0.18)	49 (0.88)	6 (0.11)	133 (2.4)	12 (0.22)	+40°F to +100°F (+4.4°C to +37.8°C)	+155°F (+68.3°C)
*V10Z 3-□□2R0625	25						1.0 (0.45)	.4 (0.18)	48 (0.86)	7 (0.13)	133 (2.4)	15 (0.27)	+40°F to +100°F (+4.4°C to +37.8°C)	+155°F (+68.3°C)
V10Z 3-□□2R0820	20	.405 (10.3)	.500 (12.7)	.375 (9.5)	.060 (1.5)	#8-32	1.0 (0.45)	.4 (0.18)	45 (0.8)	6 (0.11)	108 (1.9)	12 (0.22)	+40°F to +100°F (+4.4°C to +37.8°C)	+155°F (+68.3°C)
*V10Z 3-□□2R0825	25						1.0 (0.45)	.4 (0.18)	64 (1.14)	9 (0.16)	152 (2.7)	15 (0.27)	+40°F to +100°F (+4.4°C to +37.8°C)	+155°F (+68.3°C)

STYLE: □

MB Male-Blank  
MM Male-Male

\* Flame retardant meets V-0. UL-94 rating @ 3 mm.  
 $\Delta$  Shear load data not applicable for Male-Blank style.

NOTE: Dimensions in ( ) are mm.



# Cylindrical Mounts – Rubber – To 6 lbs.

www.vibrationmounts.com Phone: 516.328.3662 Fax: 516.328.3365

- **MATERIAL:** Fasteners – Steel, Zinc Plated  
Isolator – Synthetic Rubber

- **FOR COMPRESSION LOADS OF .3 TO 6 POUNDS (0.14 TO 2.7 kgf)**
- **FOR SHEAR LOADS OF .1 TO .3 POUNDS (0.05 TO 0.14 kgf)**

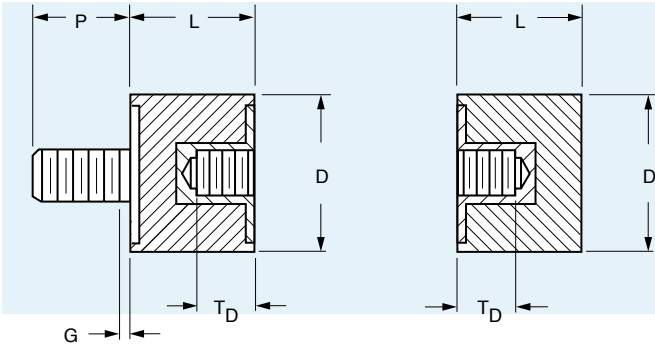

Male - Female

Female - Blank



**FEATURES:**

- Highly damped
- Oil resistant

Catalog Number	Durometer	D	L	P	G	Thread Size	T <sub>D</sub> Thread Depth	Load lb. (kgf)		Stiffness lb./in. (kgf/mm)				Temperature Range	
								Cmpr. Max.	Shear <sup>Δ</sup>	Static		Dynamic		Peak Performance	Max. Intermittent
										Cmpr.	Shear <sup>Δ</sup>	Cmpr.	Shear <sup>Δ</sup>		
V10Z 3-□□1R0420	20	.280 (7.1)	.320 (8.1)	.200 (5.1)	.060 (1.5)	#4-40	.110 (2.8)	.3 (0.14)	.1 (0.05)	128 (2.3)	13 (0.23)	205 (3.7)	20 (0.36)	+40°F to +100°F (+4.4°C to +37.8°C)	+155°F (+68.3°C)
*V10Z 3-□□1R0425	25							.3 (0.14)	.1 (0.05)	154 (2.8)	15 (0.27)	212 (3.8)	22 (0.39)	+40°F to +100°F (+4.4°C to +37.8°C)	+155°F (+68.3°C)
V10Z 3-□□2R0620	20	.405 (10.3)	.500 (12.7)	.375 (9.5)	.060 (1.5)	#6-32	.160 (4.1)	.6 (0.27)	.3 (0.14)	121 (2.2)	13 (0.23)	242 (4.3)	19 (0.34)	+40°F to +100°F (+4.4°C to +37.8°C)	+155°F (+68.3°C)
*V10Z 3-□□2R0625	25							.6 (0.27)	.3 (0.14)	159 (2.8)	16 (0.29)	428 (7.6)	22 (0.39)	+40°F to +100°F (+4.4°C to +37.8°C)	+155°F (+68.3°C)
V10Z 3-□□2R0820	20	.405 (10.3)	.500 (12.7)	.375 (9.5)	.060 (1.5)	#8-32	.160 (4.1)	.6 (0.27)	.3 (0.14)	117 (2.1)	13 (0.23)	242 (4.3)	18 (0.32)	+40°F to +100°F (+4.4°C to +37.8°C)	+155°F (+68.3°C)
*V10Z 3-□□2R0825	25							.6 (0.27)	.3 (0.14)	136 (2.4)	14 (0.25)	270 (4.8)	22 (0.39)	+40°F to +100°F (+4.4°C to +37.8°C)	+155°F (+68.3°C)

STYLE: □

FB Female-Blank  
MF Male-Female

\* Flame retardant meets V-0, UL-94 rating @ 3 mm.

Δ Shear load data not applicable for Female-Blank style.

NOTE: Dimensions in ( ) are mm.

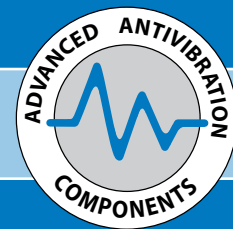

# Cylindrical Mounts – To 250 kgf

www.vibrationmounts.com Phone: 516.328.3662 Fax: 516.328.3365

- **MATERIAL:** Isolator – Rubber  
Plates & Screws – Stainless Steel

- **FOR LOADS UP TO 250 kgf (551.2 lbf)**

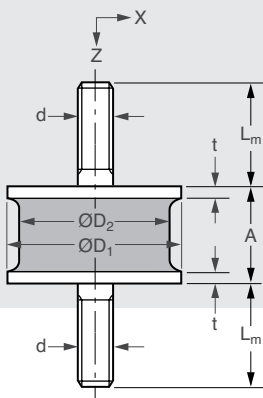

## Metric

### FEATURES:

- Simple design and economical
- Can be installed in small space
- Can support heavy loads due to the relatively high spring constant
- Allows mounting in various orientations in compression, shear and slanted angle loading

Catalog Number	A	D <sub>1</sub>	D <sub>2</sub>	L <sub>m</sub>	d	t	Nominal Load Z dir. kgf (lb.)	*Max. Allowable Load		Spring Rate in Z dir. Kz kgf/cm (lb./in.)	Stiffness Ratio Kx/Kz
								X direction kgf (lb.)	Z direction kgf (lb.)		
V11Y02MSMMKA12	16 (.63)	12 (.47)	10 (.39)	12 (.47)	M5	2 (.08)	8 (17.6)	2.5 (5.5)	11 (24.3)	42 (235)	0.2
V11Y02MSMMKA15	15 (.59)	15 (.59)	12 (.47)	15 (.59)			13 (28.7)	3.5 (7.7)	16 (35.3)	75 (420)	
V11Y02MSMMKA20	15 (.59)	20 (.79)	15 (.59)	15 (.59)	M6	2 (.08)	16 (35.3)	7 (15.4)	29 (63.9)	130 (728)	0.15
V11Y02MSMMKA25	18 (.71)	25 (.98)	20 (.79)	18 (.71)			25 (55.1)	10 (22.05)	50 (110.2)	200 (1120)	
V11Y02MSMMKA30	18 (.71)	30 (1.18)	25 (.98)	24 (.94)	M8	2 (.08)	46 (101.4)	17 (37.5)	91 (200.6)	320 (1792)	0.16
V11Y02MSMMKA35	26 (1.02)	35 (1.34)	30 (1.18)	24 (.94)			50 (110.2)	25 (55.1)	100 (220.5)	240 (1344)	
V11Y02MSMMKA40	25 (.98)	40 (1.57)	34 (1.38)	30 (1.18)			95 (209.4)	37 (81.6)	185 (407.9)	350 (1960)	
V11Y02MSMMKA50	27 (1.06)	50 (1.97)	42 (1.65)	30 (1.18)			125 (275.6)	60 (132.3)	250 (551.2)	620 (3472)	

\*Includes static and dynamic loads.

NOTE: Dimensions in ( ) are inch.



# Cylindrical Mounts – To 75 kgf

www.vibrationmounts.com Phone: 516.328.3662 Fax: 516.328.3365

• **MATERIAL:** Isolator – Rubber  
Plates & Screws – Steel

• **FOR LOADS UP TO 75 kgf (165 lbf)**

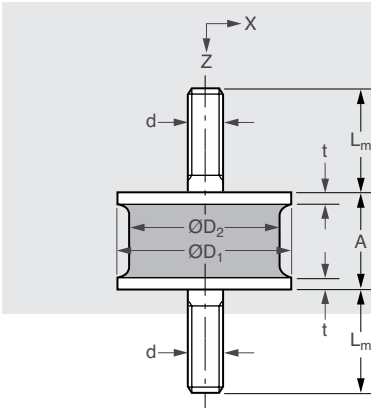

Cylindrical Mounts

## Metric

### FEATURES:

- Simple design and economical
- Can be installed in small space
- Can support heavy loads due to the relatively high spring constant
- Allows mounting in various orientations in compression, shear and slanted angle loading

Catalog Number	A	D <sub>1</sub>	D <sub>2</sub>	L <sub>m</sub>	d	t	Nominal Load Z dir. kgf (lb.)	* Max. Allowable Load		Spring Rate in Z dir. Kz kgf/cm (lb./in.)	Stiffness Ratio Kx/Kz
								X direction kgf (lb.)	Z direction kgf (lb.)		
V11Z02MMMKA008	11 (.43)	8 (.31)	8 (.31)	10 (.39)	M3	1 (.04)	2.1 (4.6)	0.7 (1.5)	3.7 (8.2)	17 (95.2)	0.17
V11Z02MMMKA010	13 (.51)	10 (.39)	10 (.39)		M4		3.5 (7.7)	1 (2.2)	5.9 (13)	22 (123)	
V11Z02MMMKA012	16 (.63)	12 (.47)	10 (.39)	12 (.47)	M5	2 (.08)	8 (17.6)	2.5 (5.5)	11 (24.3)	42 (235)	0.2
V11Z02MMMKA015	15 (.59)	15 (.59)	12 (.47)				15 (.59)	13 (28.7)	3.5 (7.7)	16 (35.3)	
V11Z02MMMKA020	15 (.59)	20 (.78)	15 (.59)	15 (.59)	M6	2 (.08)	16 (35.3)	7 (15.4)	29 (63.9)	130 (728)	0.15
V11Z02MMMKA020H	20 (.79)						10 (22)	5 (11)	18 (39.7)	80 (448)	
V11Z02MMMKA025	18 (.71)	25 (.98)	20 (.78)	18 (.71)	M6	2.3 (.09)	25 (55.1)	10 (22)	50 (110.2)	200 (1120)	0.16
V11Z02MMMKA025H	27 (1.06)						16 (35.3)	6 (13.2)	32 (70.5)	95 (532)	
V11Z02MMMKA030	18 (.71)	30 (1.18)	25 (.98)	24 (.95)	M8	2.3 (.09)	46 (101.4)	17 (37.5)	91 (200.6)	320 (1792)	0.16
V11Z02MMMKA030H	26 (1.02)						31 (68.3)	12 (26.5)	62 (136.7)	145 (812)	
V11Z02MMMKA035	26 (1.02)	35 (1.38)	30 (1.18)	24 (.95)	M8	2.3 (.09)	50 (110.2)	25 (55.1)	100 (220.5)	240 (1344)	0.17
V11Z02MMMKA035H	35 (1.38)						38 (83.8)	20 (44.1)	75 (165.4)	150 (840)	

\*Includes static and dynamic loads.  
**NOTE:** Dimensions in ( ) are inch.

Continued on the next page

# Cylindrical Mounts – To 2600 kgf

www.vibrationmounts.com Phone: 516.328.3662 Fax: 516.328.3365

• **MATERIAL:** Isolator – Rubber  
Plates & Screws – Steel

• **FOR LOADS UP TO 2600 kgf (5732 lbf)**

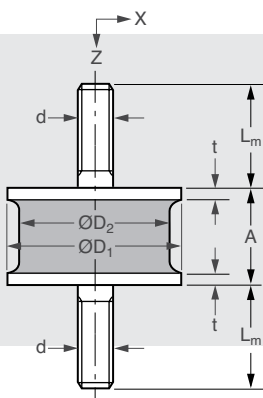

## Metric

### FEATURES:

- Simple design and economical
- Can be installed in small space
- Can support heavy loads due to the relatively high spring constant
- Allows mounting in various orientations in compression, shear and slanted angle loading

Catalog Number	A	D <sub>1</sub>	D <sub>2</sub>	L <sub>m</sub>	d	t	Nominal Loads Z dir. kgf (lb.)	* Max. Allowable Load		Spring Rate in Z dir. Kz kgf/cm (lb./in.)	Stiffness Ratio Kx/Kz
								X direction kgf (lb.)	Z direction kgf (lb.)		
V11Z02MMMKA040	25 (.98)	40 (1.57)	34 (1.34)	30 (1.18)	M8	2.3 (.09)	95 (209.4)	37 (81.6)	185 (407.9)	350 (1960)	0.17
V11Z02MMMKA040H	33 (1.30)						55 (121.3)	25 (55.1)	110 (242.5)	220 (1232)	
V11Z02MMMKA050	27 (1.06)	50 (1.97)	42 (1.65)	30 (1.18)	M10	3.2 (.13)	125 (275.6)	60 (132.3)	250 (551.2)	620 (3472)	0.17
V11Z02MMMKA050H	40 (1.57)						90 (198.4)	40 (88.2)	180 (396.8)	280 (1568)	
V11Z02MMMKA060	30 (1.18)	60 (2.36)	52 (2.05)	35 (1.38)	M12	3.2 (.13)	190 (418.9)	76 (167.6)	380 (837.7)	800 (4480)	0.16
V11Z02MMMKA060H	34 (1.34)						215 (474)	95 (209.4)	430 (948)	660 (3696)	
V11Z02MMMKA080	40 (1.57)	80 (3.15)	70 (2.76)	45 (1.77)	M12	4.5 (.18)	425 (937)	200 (440.9)	850 (1873.9)	1380 (7728)	0.15
V11Z02MMMKA100	50 (1.97)						630 (1389)	250 (551.2)	1260 (2777.8)	1640 (9184)	
V11Z02MMMKA120	60 (2.36)	120 (4.72)	110 (4.33)	51 (2.01)	M16	8 (.31)	785 (1730.6)	315 (694.5)	1570 (3461.2)	2200 (12320)	0.13
V11Z02MMMKA150	62 (2.44)						1300 (2866)	520 (1146.4)	2600 (5732)	4050 (22680)	

\*Includes static and dynamic loads.

NOTE: Dimensions in ( ) are inch.