

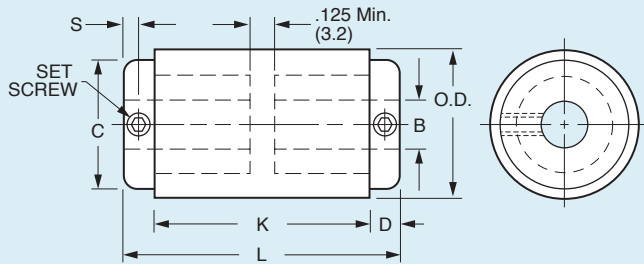

Couplings – Flexible – Geargrip

www.vibrationmounts.com Phone: 516.328.3662 Fax: 516.328.3365

- **MATERIAL:** Sleeve – Neoprene with Ground O.D.
Hubs – Zinc Alloy Die Casting

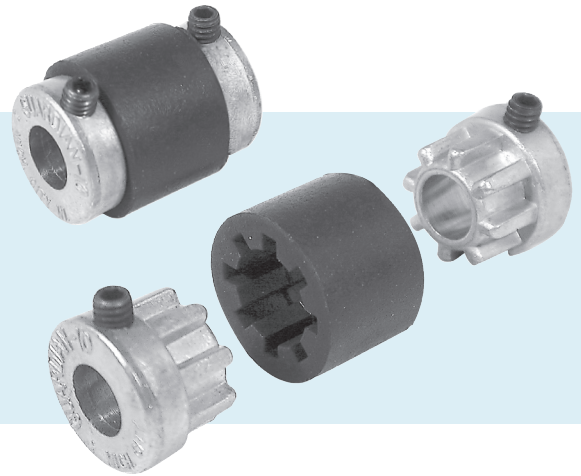

FEATURES:

- No Lubrication
- Electrically Isolated
- Dampens Shock & Vibration

Dimensions in () are mm.

Coupling Size	Nominal Torque lb. in. (N • m)	H.P. @ 1750 rpm	Max. Angular Offset	Max. Lateral Offset	Max. Speed rpm	Operating Temperature
11	4 (0.5)	.11	7.5°	.016 (0.4)	25,000	250° F Max. (121° C)
18	16 (1.8)	.44		.040 (1.02)	16,800	
21	30 (3.4)	.83		.040 (1.02)	16,500	
31	60 (6.8)	1.70		.040 (1.02)	15,500	

Catalog Number			B Bore +.002 (0.050) -.001 (0.025)	O.D. ±.030 (±0.76)	L ±.030 (±0.76)	C	D	K ±1/16 (±1.6)	S	Set Screw
Complete Coupling	Hub Only	Sleeve Only								
V 5Z 1-1104	V 5D 1-1104	V 5R 1-11	.125 (3.18)	.80 (20.3)	1 (25.4)	.70 (17.8)	7/32 (5.6)	.56 (14.2)	1/8 (3.2)	#8-32
V 5Z 1-1106	V 5D 1-1106		.188 (4.78)							
V 5Z 1-1108	V 5D 1-1108		.250 (6.35)							
V 5Z 1-1110	V 5D 1-1110		.3125 (7.94)							
V 5Z 1-1112	V 5D 1-1112	.375 (9.53)	1.20 (30.5)	1-1/2 (38.1)	1.15 (29.2)	5/16 (7.9)	.85 (21.6)	5/32 (4)	1/4-20	
V 5Z 1-1810	V 5D 1-1810	.3125 (7.94)								
V 5Z 1-1812	V 5D 1-1812	.375 (9.53)								
V 5Z 1-1814	V 5D 1-1814	.438 (11.13)								
V 5Z 1-1816	V 5D 1-1816	.500 (12.7)	1.20 (30.5)	2-1/4 (57.2)	1.15 (29.2)	5/16 (7.9)	1-19/32 (40.5)	5/32 (4)	1/4-20	
V 5Z 1-2110	V 5D 1-2110	.3125 (7.94)								
V 5Z 1-2112	V 5D 1-2112	.375 (9.53)								
V 5Z 1-2114	V 5D 1-2114	.438 (11.13)								
V 5Z 1-2116	V 5D 1-2116	.500 (12.7)	1.40 (35.5)	2-3/8 (60.3)	1.45 (36.8)	3/8 (9.5)	1-19/32 (40.5)	3/16 (4.8)	1/4-20	
V 5Z 1-3112	V 5D 1-3112	.375 (9.53)								
V 5Z 1-3114	V 5D 1-3114	.438 (11.13)								