



# Spring Mounts – Pedestal Type

www.vibrationmounts.com Phone: 516.328.3662 Fax: 516.328.3365

- MATERIAL: Mounting Plates – Steel, Cadmium Plated  
Springs – Spring Steel Wire

- ALL METAL

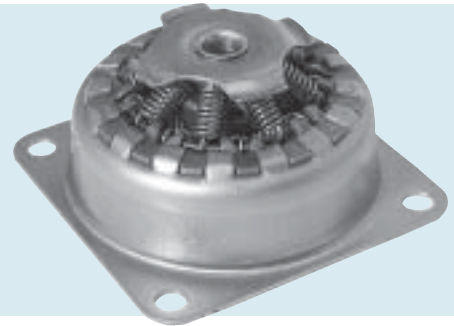
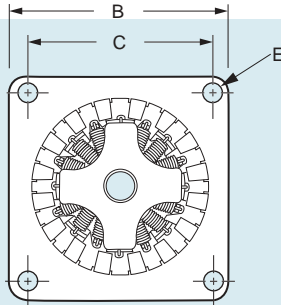
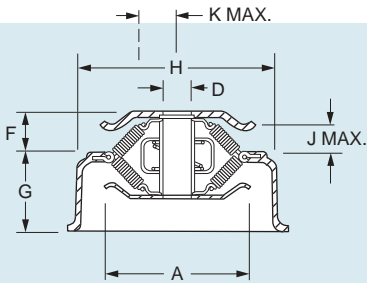

J Designates vertical displacement  
K Designates radial displacement

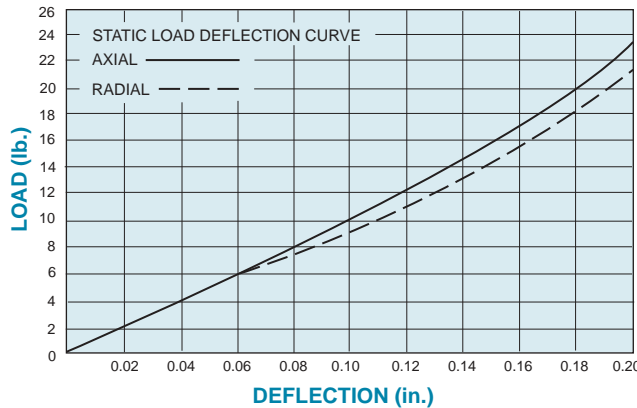

TEMPERATURE RANGE: -76°F to +302°F  
-60°C to +150°C

Catalog Number	Nominal Load		Weight		Dimensions					
	lb.	kgf	oz.	kg		in.	mm		in.	mm
<b>LIGHT-DUTY</b>										
V10C17-LP199301	1	0.45			A	7/8	22.23	F	15/64	5.95
V10C17-LP199402	2	0.91	.71	0.021	B	1-11/16	42.85	G	9/16	14.29
V10C17-LP199503	3	1.36			C	1-3/8	34.93	H	1-9/16	39.67
V10C17-LP199604	4	1.81			D	.170	4.22	J	5/32	3.97
					E	.150	3.73	K	1/8	3.18
<b>MEDIUM-DUTY</b>										
V10C17-MP199702	2	0.91			A	1-1/4	31.75	F	21/64	8.33
V10C17-MP199804	4	1.81			B	2-3/8	60.33	G	13/16	20.64
V10C17-MP199906	6	2.72	2.05	0.061	C	1-15/16	49.20	H	2-25/32	70.64
V10C17-MP235008	8	3.63			D	.257	6.53	J	3/16	4.76
V10C17-MP235110	10	4.54			E	.196	4.98	K	3/16	4.76
V10C17-MP235212	12	5.44								
V10C17-MP370914	14	6.35								
<b>HEAVY-DUTY</b>										
V10C17-HP235310	10	4.54			A	1-3/4	44.45	F	31/64	12.30
V10C17-HP235415	15	6.80			B	3.0	76.20	G	1-3/32	29.37
V10C17-HP235520	20	9.07	3.01	0.138	C	2-1/2	63.5	H	2-3/4	69.85
V10C17-HP235625	25	11.34			D	.39	9.93	J	1/4	6.35
V10C17-HP235730	30	13.61			E	.26	6.53	K	3/16	4.76
V10C17-HP371035	35	15.88								

NOTE: Curves shown for mounts with a nominal load rating of 6 pounds.

Deflection curve for mounts with other load ratings may be drawn by shifting the curve shown to pass through a point defined by the intersection of the mounts nominal load (pounds) with a standard deflection of .06 inches.