



Cylindrical Mounts – To 13.3 lbs.

www.vibrationmounts.com Phone: 516.328.3662 Fax: 516.328.3365

- **MATERIAL:** Fasteners – Steel, Zinc Plated
Isolator – Natural Rubber

- **FOR COMPRESSION LOADS OF 4.9 TO 13.3 POUNDS (2.2 TO 6 kgf)**
- **FOR SHEAR LOADS OF 2.7 TO 6.4 POUNDS (1.2 TO 2.9 kgf)**

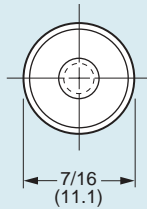
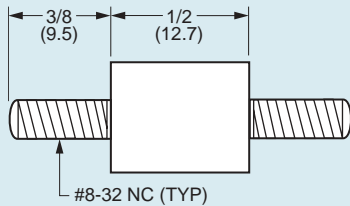

NOTE: Dimensions in () are mm.

NOTE:

Maximum unthreaded portion of stud does not exceed 1/16 inch (1.59 mm).

LOAD DEFLECTION GRAPHS

Deflections below the line x-x are considered safe practice for static loads; data above that line are useful for calculating deflections under dynamic loads.

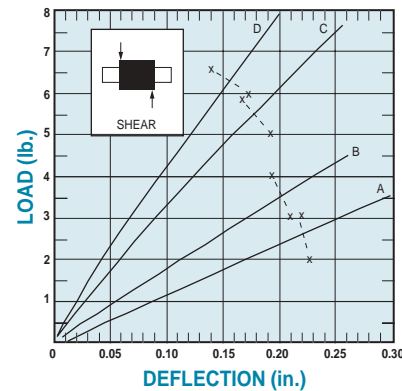
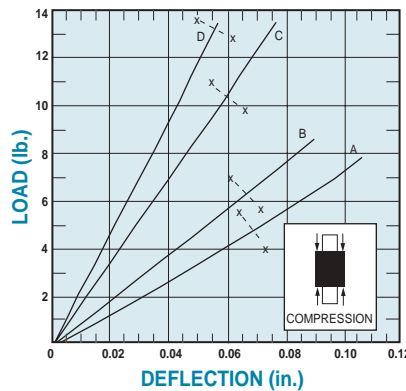

Catalog Number	Mode	Maximum Load lb. (kgf)	Forcing Frequency in Cycles per Minute									
			1000	1250	1500	1750	2000	2250	2500	2750	3000	3600
			Minimum Load for 81% Isolation lb. (kgf)									
V10Z 2-302A	Compression	4.9 (2.2)	—	—	—	—	3.9 (1.8)	3.0 (1.4)	2.4 (1.1)	2.0 (0.9)	1.8 (0.8)	1.0 (0.5)
	Shear	2.7 (1.22)	2.6 (1.2)	1.7 (0.8)	1.2 (0.54)	1.0 (0.5)	.7 (0.3)	.5 (0.2)	*	*	*	*
V10Z 2-302B	Compression	6.4 (2.9)	—	—	—	—	5.3 (2.4)	4.2 (1.9)	3.4 (1.5)	2.9 (1.3)	2.5 (1.1)	1.5 (0.7)
	Shear	3.6 (1.6)	—	2.6 (1.2)	1.9 (0.9)	1.4 (0.6)	1.1 (0.5)	.8 (0.4)	.7 (0.3)	.6 (0.27)	*	*
V10Z 2-302C	Compression	10.4 (4.7)	—	—	—	—	9.8 (4.4)	7.7 (3.5)	6.3 (2.9)	5.2 (2.4)	4.3 (1.9)	2.6 (1.2)
	Shear	5.6 (2.5)	—	4.7 (2.1)	3.2 (1.5)	2.5 (1.1)	1.9 (0.9)	1.5 (0.7)	1.3 (0.6)	1.1 (0.5)	.9 (0.4)	.7 (0.3)
V10Z 2-302D	Compression	13.3 (6)	—	—	—	—	13.1 (5.9)	10.4 (4.7)	8.5 (3.9)	7.0 (3.2)	5.8 (2.6)	4.2 (1.9)
	Shear	6.4 (2.9)	—	6.1 (2.8)	4.4 (2)	3.4 (1.5)	2.7 (1.2)	2.2 (1)	1.8 (0.8)	1.6 (0.7)	1.4 (0.6)	1.0 (0.45)

*At these forcing frequencies, lesser loads will yield less than 81% isolation.



Cylindrical Mounts – To 25 lbs.

www.vibrationmounts.com Phone: 516.328.3662 Fax: 516.328.3365

- **MATERIAL:** Fasteners – Hardened Steel, Zinc Plated
Isolater – Natural Rubber
- **FOR COMPRESSION LOADS OF 8 TO 25 POUNDS (3.6 TO 11.3 kgf)**
- **FOR SHEAR LOADS OF 4.4 TO 12.5 POUNDS (2 TO 5.7 kgf)**

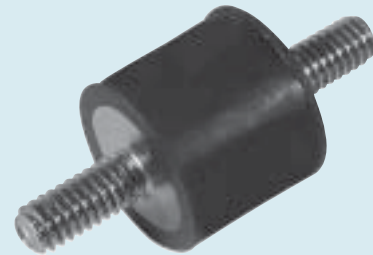
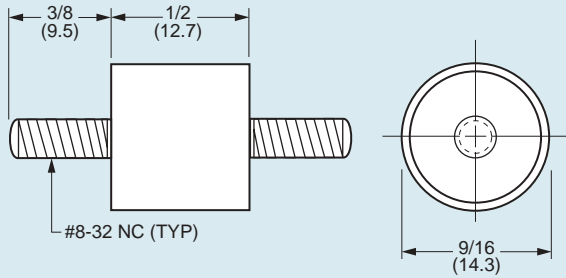

NOTE: Dimensions in () are mm.

NOTE:

Maximum unthreaded portion of stud does not exceed 1/16 inch (1.59 mm).

LOAD DEFLECTION GRAPHS

Deflections below the line x-x are considered safe practice for static loads; data above that line are useful for calculating deflections under dynamic loads.

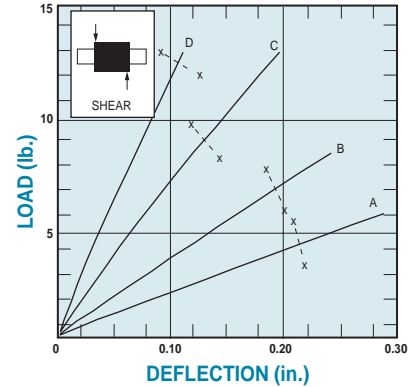
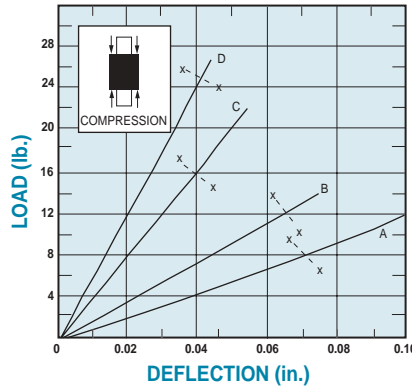

Compression		Forcing Frequency in Cycles per Minute									
Catalog Number	Maximum Load lb. (kgf)	1000	1250	1500	1750	2000	2250	2500	2750	3000	3600
		Minimum Load for 81% Isolation lb. (kgf)									
V10Z 2-301A	8.0 (3.6)	—	—	—	—	6.2 (2.8)	4.8 (2.2)	4.0 (1.8)	3.2 (1.5)	2.7 (1.2)	2.0 (0.9)
V10Z 2-301B	12.0 (5.4)	—	—	—	—	10.2 (4.6)	8.0 (3.6)	6.5 (2.9)	5.4 (2.4)	4.5 (2)	3.2 (1.5)
V10Z 2-301C	16.0 (7.3)	—	—	—	—	—	—	14.0 (6.4)	11.6 (5.3)	9.6 (4.4)	6.8 (3.1)
V10Z 2-301D	25.0 (11.3)	—	—	—	—	—	—	22.0 (10)	18.2 (8.3)	15.2 (6.9)	10.4 (4.7)

Shear		Forcing Frequency in Cycles per Minute									
Catalog Number	Maximum Load lb. (kgf)	1000	1250	1500	1750	2000	2250	2500	2750	3000	3600
		Minimum Load for 81% Isolation lb. (kgf)									
V10Z 2-301A	4.4 (2)	4.0 (1.8)	3.1 (1.4)	2.2 (1)	1.7 (0.77)	1.3 (0.6)	*	*	*	*	*
V10Z 2-301B	6.7 (3)	6.5 (2.9)	5.2 (2.4)	3.7 (1.7)	2.8 (1.27)	2.3 (1.04)	1.8 (0.82)	*	*	*	*
V10Z 2-301C	9.0 (4.1)	—	9.0 (4.1)	6.3 (2.9)	4.6 (2.1)	3.6 (1.6)	2.9 (1.32)	2.3 (1.04)	1.9 (0.9)	*	*
V10Z 2-301D	12.5 (5.7)	—	—	11.2 (5.1)	8.2 (3.7)	6.3 (2.9)	4.0 (1.8)	4.0 (1.8)	3.3 (1.5)	2.8 (1.3)	2.0 (0.9)

*At these forcing frequencies, lesser loads will yield less than 81% isolation.



Cylindrical Mounts – To 28.5 lbs.

www.vibrationmounts.com Phone: 516.328.3662 Fax: 516.328.3365

- **MATERIAL:** Fasteners – Steel, Zinc Plated
Isolator – Natural Rubber

- **FOR COMPRESSION LOADS OF 22 TO 28.5 POUNDS (10 TO 12.9 kgf)**
- **FOR SHEAR LOADS OF 8.4 TO 11.9 POUNDS (3.8 TO 5.4 kgf)**

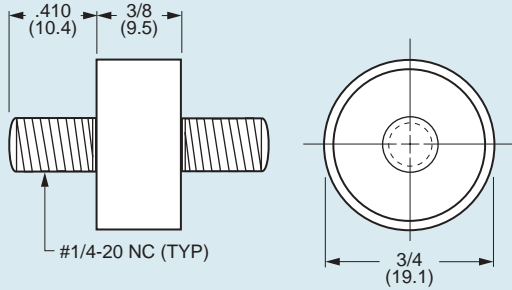

NOTE: Dimensions in () are mm.

NOTE:

Maximum unthreaded portion of stud does not exceed 1/16 inch (1.59 mm).

LOAD DEFLECTION GRAPHS

Deflections below the line x-x are considered safe practice for static loads; data above that line are useful for calculating deflections under dynamic loads.

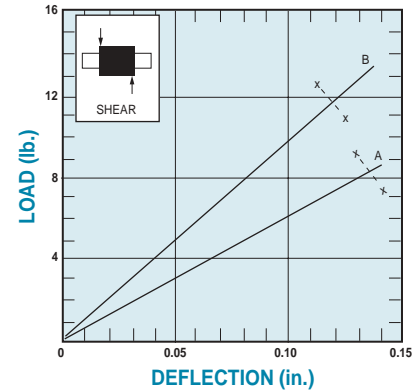
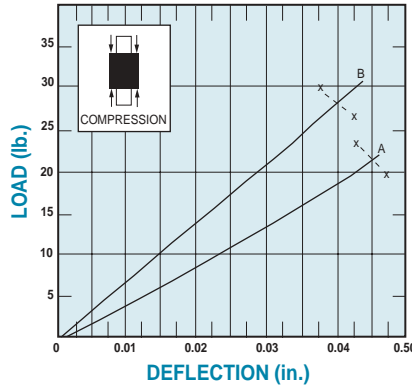

Catalog Number	Mode	Maximum Load lb. (kgf)	Forcing Frequency in Cycles per Minute						
			1500	1750	2000	2250	2500	3000	3600
			Minimum Load for 81% Isolation lb. (kgf)						
V10Z 2-307A	Compression	22.0 (10)	—	—	—	21.5 (9.8)	16.5 (7.5)	10.5 (4.8)	6.5 (2.9)
	Shear	8.4 (3.8)	6.2 (2.8)	4.7 (2.1)	3.7 (1.7)	3.0 (1.4)	2.4 (1.09)	2.5 (1.13)	*
V10Z 2-307B	Compression	28.5 (12.9)	—	—	—	—	25.5 (11.6)	17.0 (7.7)	12.0 (5.4)
	Shear	11.9 (5.4)	9.9 (4.5)	7.3 (3.3)	5.6 (2.5)	4.4 (2)	3.6 (1.6)	*	*

*At these forcing frequencies, lesser loads will yield less than 81% isolation.



Cylindrical Mounts – To 75 lbs.

www.vibrationmounts.com Phone: 516.328.3662 Fax: 516.328.3365

- **MATERIAL:** Fasteners – Steel, Zinc Plated
Isolator – Natural Rubber

- **FOR COMPRESSION LOADS OF 40 TO 75 POUNDS (18.1 TO 34 kgf)**
• **FOR SHEAR LOADS OF 19 TO 42 POUNDS (8.6 TO 19.1 kgf)**

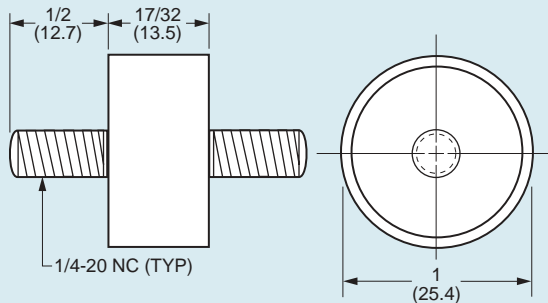

NOTE: Dimensions in () are mm.

NOTE:
Maximum unthreaded portion of stud does not exceed 1/16 inch (1.59 mm).

LOAD DEFLECTION GRAPHS
Deflections below the line x-x are considered safe practice for static loads; data above that line are useful for calculating deflections under dynamic loads.

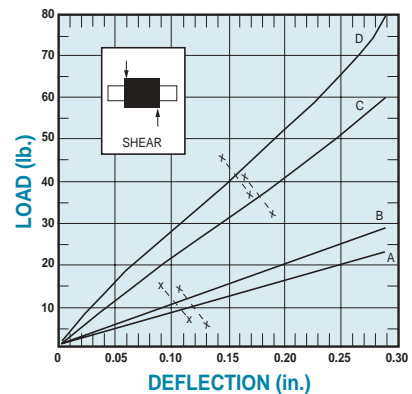
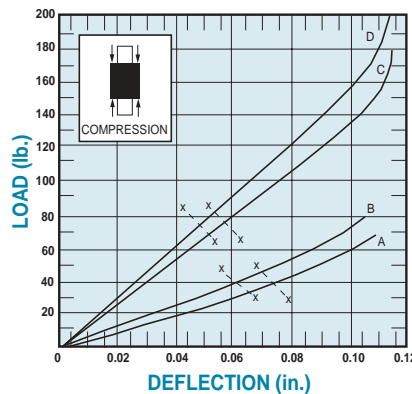

Compression		Forcing Frequency in Cycles per Minute									
Catalog Number	Maximum Load lb. (kgf)	1100	1250	1500	1750	2000	2250	2500	2750	3000	3600
		Minimum Load for 81% Isolation lb. (kgf)									
V10Z 2-305A	40 (18.1)	—	—	—	—	30.5 (13.8)	24.0 (10.9)	19.5 (8.8)	16.0 (7.3)	13.5 (6.1)	10.0 (4.5)
V10Z 2-305B	43 (19.5)	—	—	—	—	38.0 (17.2)	30.0 (13.6)	24.8 (11.2)	20.5 (9.3)	17.5 (7.9)	12.5 (5.7)
V10Z 2-305C	74 (33.6)	—	—	—	—	74.0 (33.6)	58.5 (26.5)	47.5 (21.5)	39.5 (17.9)	33.0 (15)	23.5 (10.7)
V10Z 2-305D	75 (34)	—	—	—	—	—	67.5 (30.6)	55.5 (25.2)	45.5 (20.6)	38.5 (17.5)	27.5 (12.5)

Shear		Forcing Frequency in Cycles per Minute									
Catalog Number	Maximum Load lb. (kgf)	1100	1250	1500	1750	2000	2250	2500	2750	3000	3600
		Minimum Load for 81% Isolation lb. (kgf)									
V10Z 2-305A	19 (8.6)	15.7 (7.1)	12.5 (5.7)	8.3 (3.8)	6.3 (2.9)	*	*	*	*	*	*
V10Z 2-305B	21 (9.5)	19.0 (8.6)	15.5 (7)	10.6 (4.8)	8.0 (3.6)	6.3 (2.9)	5.0 (2.3)	*	*	*	*
V10Z 2-305C	37 (16.8)	—	31.5 (14.3)	22.5 (10.2)	17.0 (7.7)	14.0 (6.4)	11.5 (5.2)	9.5 (4.3)	*	*	*
V10Z 2-305D	42 (19.1)	—	40.0 (18.1)	29.5 (13.4)	22.0 (10)	18.5 (8.4)	15.8 (7.2)	13.0 (5.9)	11.0 (5)	9.5 (4.3)	*

*At these forcing frequencies, lesser loads will yield less than 81% isolation.



Cylindrical Mounts – To 79 lbs.

www.vibrationmounts.com Phone: 516.328.3662 Fax: 516.328.3365

- **MATERIAL:** Fasteners – Steel, Zinc Plated
Isolater – Natural Rubber

- **FOR COMPRESSION LOADS OF 33 TO 79 POUNDS (15 TO 35.8 kgf)**
• **FOR SHEAR LOADS OF 18 TO 40 POUNDS (8.2 TO 18.1 kgf)**

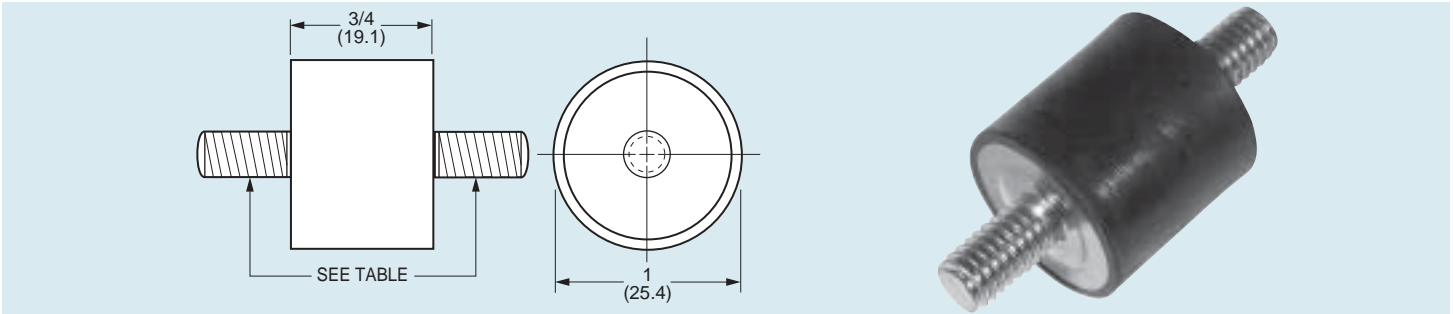

NOTE: Dimensions in () are in mm.

LOAD DEFLECTION GRAPHS
Deflections below the line x-x are considered safe practice for static loads; data above that line are useful for calculating deflections under dynamic loads.

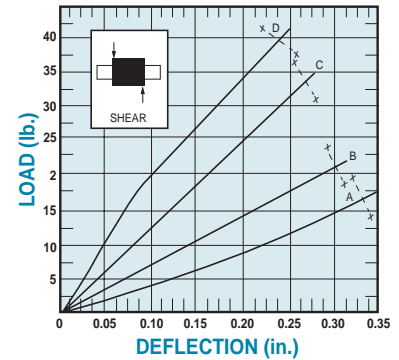
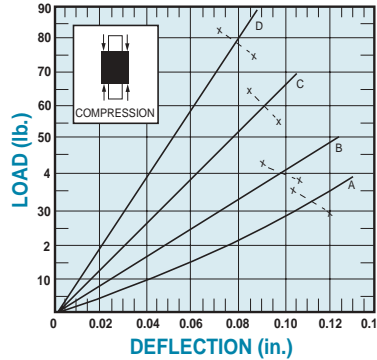

Catalog Number	Thread	Thread Length
V10Z 2-300 <input type="checkbox"/> ^Δ	1/4-20 NC	1/2 (12.7)
V10Z 2-317 <input type="checkbox"/> ^Δ	5/16-18 NC	9/16 (14.3)

NOTE: Maximum unthreaded portion of stud does not exceed 1/16 inch (1.6 mm).

^ΔLoad Rating A, B, C, or D, see table below.

Compression		Forcing Frequency in Cycles per Minute									
Load Rating	Maximum Load lb. (kgf)	850	1100	1250	1500	1750	2000	2250	2500	3000	3600
		Minimum Load for 81% Isolation lb. (kgf)									
A	33 (15)	—	—	—	29.0 (13.2)	21.0 (9.5)	16.0 (7.3)	12.5 (5.7)	10.5 (4.8)	7.0 (3.2)	5.0 (2.3)
B	40 (18.1)	—	—	—	39.5 (18)	28.5 (12.9)	21.5 (9.8)	17.0 (7.7)	14.0 (6.4)	9.5 (4.3)	7.0 (3.2)
C	60 (27.2)	—	—	—	—	49.0 (22.2)	37.0 (16.8)	29.5 (13.4)	24.0 (10.9)	17.0 (7.7)	11.5 (5.2)
D	79 (35.8)	—	—	—	—	72.5 (32.9)	55.0 (24.9)	43.5 (19.7)	36.0 (16.3)	24.5 (11.1)	17.0 (7.7)

Shear		Forcing Frequency in Cycles per Minute									
Load Rating	Maximum Load lb. (kgf)	850	1100	1250	1500	1750	2000	2250	2500	3000	3600
		Minimum Load for 81% Isolation lb. (kgf)									
A	18 (8.2)	16.0 (7.3)	9.3 (4.2)	7.2 (3.3)	5.0 (2.3)	3.8 (1.7)	2.8 (1.3)	2.3 (1)	1.8 (0.8)	1.2 (0.5)	*
B	21 (9.5)	—	13.0 (5.9)	10.2 (4.6)	7.0 (3.2)	5.3 (2.4)	4.0 (1.8)	3.2 (1.5)	2.6 (1.2)	1.8 (0.8)	*
C	34 (15.4)	—	24.5 (11.1)	20.0 (9.1)	14.7 (6.7)	11.2 (5.1)	9.0 (4.1)	7.5 (3.4)	6.2 (2.8)	4.5 (2)	11.5 (1.6)
D	40 (18.1)	—	32.0 (14.5)	26.0 (11.8)	19.0 (8.6)	14.8 (6.7)	12.0 (5.4)	10.0 (4.5)	8.3 (3.8)	6.0 (2.7)	17.0 (2.3)

*At these forcing frequencies, lesser loads will yield less than 81% isolation.



Cylindrical Mounts – To 86 lbs.

www.vibrationmounts.com Phone: 516.328.3662 Fax: 516.328.3365

- **MATERIAL: Fasteners – Steel, Zinc Plated**
Isolator – Natural Rubber

- **FOR COMPRESSION LOADS OF 37 TO 86 POUNDS (16.8 TO 39 kgf)**
- **FOR SHEAR LOADS OF 16 TO 43 POUNDS (7.3 TO 19.5 kgf)**

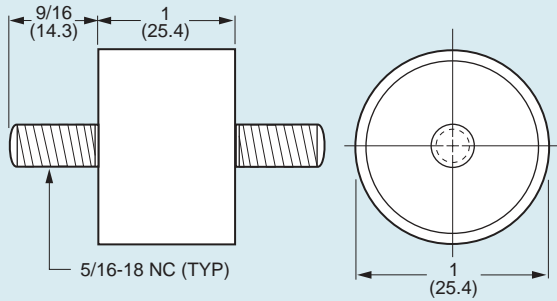

NOTE: Dimensions in () are mm.

NOTE:

Maximum unthreaded portion of stud does not exceed 1/16 inch (1.59 mm).

LOAD DEFLECTION GRAPHS

Deflections below the line x-x are considered safe practice for static loads; data above that line are useful for calculating deflections under dynamic loads.

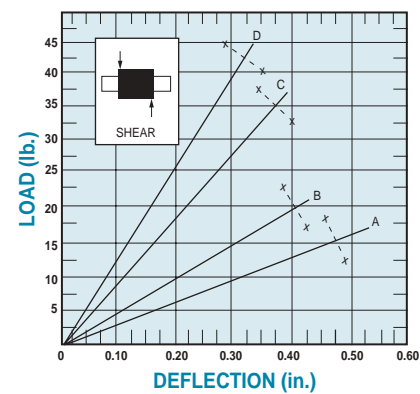
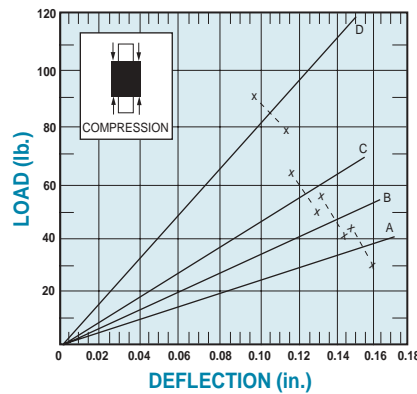

Compression		Forcing Frequency in Cycles per Minute									
Catalog Number	Maximum Load lb. (kgf)	700	950	1100	1250	1500	1750	2000	2250	2500	3000
		Minimum Load for 81% Isolation lb. (kgf)									
V10Z 2-316A	37 (16.8)	—	—	—	35.0 (15.9)	24.0 (10.9)	18.0 (8.2)	13.5 (6.1)	11.0 (5)	—	—
V10Z 2-316B	48 (21.8)	—	—	—	—	34.0 (15.4)	26.0 (11.8)	20.5 (9.3)	16.0 (7.3)	13.0 (5.9)	—
V10Z 2-316C	57 (25.9)	—	—	—	—	46.0 (20.9)	32.5 (14.8)	26.5 (12)	20.0 (9.1)	16.0 (7.3)	—
V10Z 2-316D	86 (39)	—	—	—	—	80.0 (36.3)	59.0 (26.8)	48.0 (21.8)	38.0 (17.2)	30.0 (13.6)	29.0 (9.5)

Shear		Forcing Frequency in Cycles per Minute									
Catalog Number	Maximum Load lb. (kgf)	700	950	1100	1250	1500	1750	2000	2250	2500	3000
		Minimum Load for 81% Isolation lb. (kgf)									
V10Z 2-316A	16 (7.3)	16 (7.3)	8 (3.6)	6.5 (2.9)	5.0 (2.3)	3.5 (1.6)	*	*	*	*	*
V10Z 2-316B	21 (9.5)	—	12 (5.7)	9.5 (4.3)	7.5 (3.4)	5.5 (2.5)	4.0 (1.8)	*	*	*	*
V10Z 2-316C	35 (15.9)	—	23.5 (10.7)	18.0 (8.2)	14.0 (6.4)	10.0 (4.5)	7.5 (3.4)	6.0 (2.7)	*	*	*
V10Z 2-316D	43 (19.5)	—	32.0 (14.5)	24.5 (11.1)	19.0 (8.6)	13.0 (5.9)	9.5 (4.3)	7.5 (3.4)	*	*	*

*At these forcing frequencies, lesser loads will yield less than 81% isolation.



Cylindrical Mounts – To 105 lbs.

www.vibrationmounts.com Phone: 516.328.3662 Fax: 516.328.3365

- MATERIAL: Fasteners – Steel, Zinc Plated
Isolator – Natural Rubber

- FOR COMPRESSION LOADS OF 47 TO 105 POUNDS (21.3 TO 47.6 kgf)
- FOR SHEAR LOADS OF 27 TO 66 POUNDS (12.2 TO 29.9 kgf)

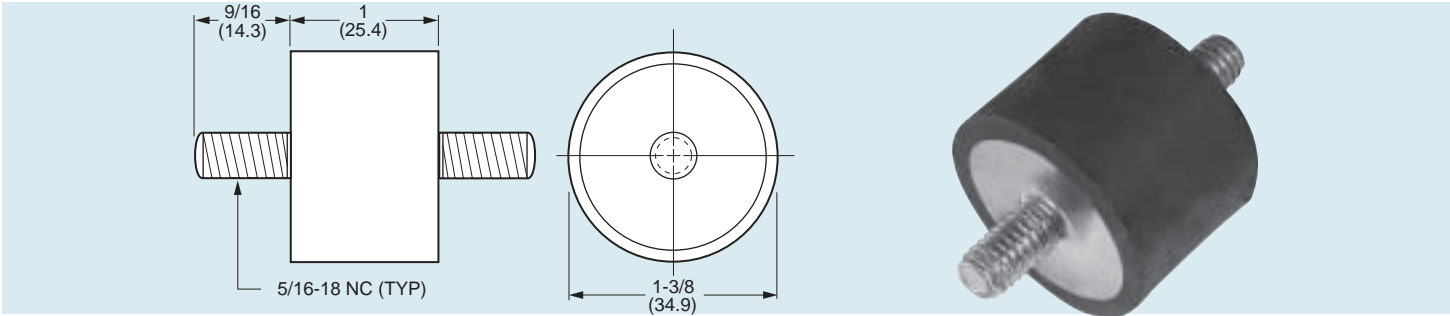

NOTE: Dimensions in () are mm.

LOAD DEFLECTION GRAPHS
Deflections below the line x-x are considered safe practice for static loads; data above that line are useful for calculating deflections under dynamic loads.

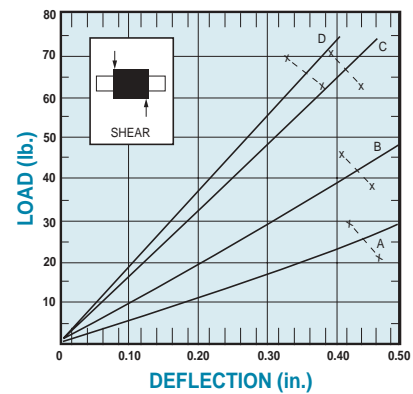
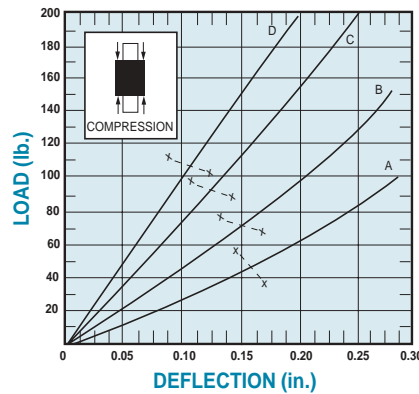

Compression		Forcing Frequency in Cycles per Minute									
Catalog Number	Maximum Load lb. (kgf)	700	950	1100	1250	1500	1750	2000	2250	2500	3000
		Minimum Load for 81% Isolation lb. (kgf)									
V10Z 2-311A	47 (21.3)	—	—	—	44.5 (20.2)	30.0 (13.6)	22.0 (10)	18.0 (8.2)	13.5 (6.1)	11.0 (5)	—
V10Z 2-311B	74 (33.6)	—	—	—	72.5 (32.9)	48.5 (22)	35.5 (16.1)	27.0 (12.2)	21.0 (9.5)	17.5 (7.9)	12.5 (5.7)
V10Z 2-311C	96 (43.5)	—	—	—	—	75.7 (34.3)	55.5 (25.2)	43.0 (19.5)	34.0 (15.4)	28.0 (12.7)	19.5 (8.8)
V10Z 2-311D	105 (47.6)	—	—	—	—	100.0 (45.4)	73.0 (33.1)	56.5 (25.6)	45.0 (20.4)	38.0 (17.2)	25.5 (11.6)

Shear		Forcing Frequency in Cycles per Minute									
Catalog Number	Maximum Load lb. (kgf)	700	950	1100	1250	1500	1750	2000	2250	2500	3000
		Minimum Load for 81% Isolation lb. (kgf)									
V10Z 2-311A	27 (12.2)	27.0 (12.2)	19.5 (8.8)	11.5 (5.2)	9.0 (4.1)	6.0 (2.7)	*	*	*	*	*
V10Z 2-311B	41 (18.6)	—	31.0 (14.1)	19.0 (8.6)	14.5 (6.6)	10.5 (4.8)	8.0 (3.6)	*	*	*	*
V10Z 2-311C	66 (29.9)	—	53.5 (24.3)	33.0 (15)	26.5 (12)	19.0 (8.6)	14.0 (6.4)	11.5 (5.2)	9.0 (4.1)	*	*
V10Z 2-311D	66 (29.9)	—	61.0 (27.7)	38.0 (17.2)	30.5 (13.8)	22.0 (10)	19.5 (8.8)	13.0 (5.9)	10.5 (4.8)	8.5 (3.9)	*

*At these forcing frequencies, lesser loads will yield less than 81% isolation.



Cylindrical Mounts – To 120 lbs.

www.vibrationmounts.com Phone: 516.328.3662 Fax: 516.328.3365

- **MATERIAL:** Fasteners – Steel, Zinc Plated
Isolator – Natural Rubber

- **FOR COMPRESSION LOADS OF 41 TO 120 POUNDS (18.6 TO 54.4 kgf)**
- **FOR SHEAR LOADS OF 21 TO 63 POUNDS (9.5 TO 28.6 kgf)**

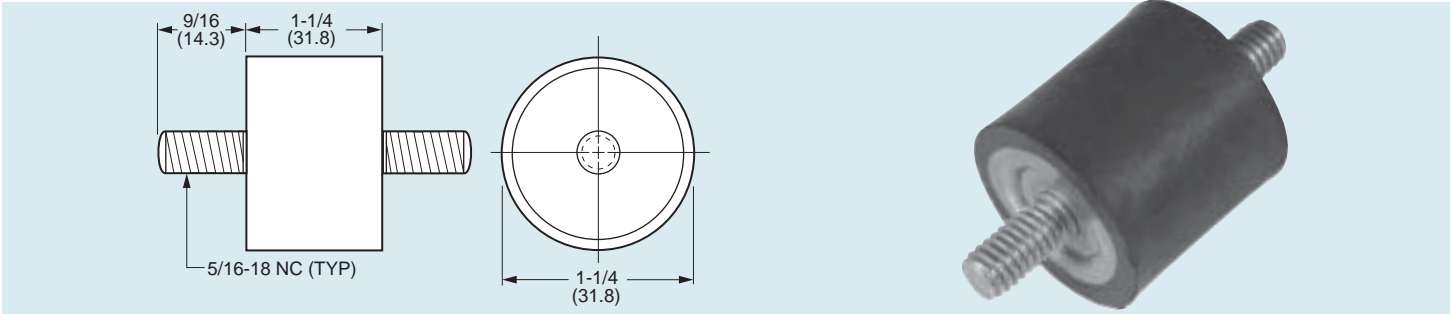

NOTE: Dimensions in () are mm.

LOAD DEFLECTION GRAPHS
Deflections below the line x-x are considered safe practice for static loads; data above that line are useful for calculating deflections under dynamic loads.

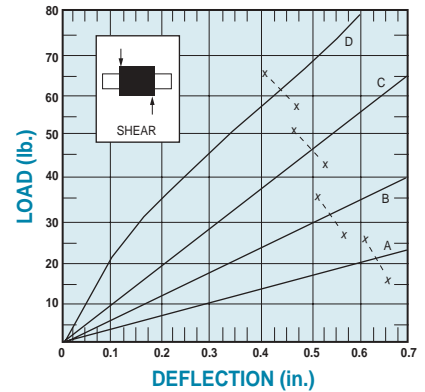
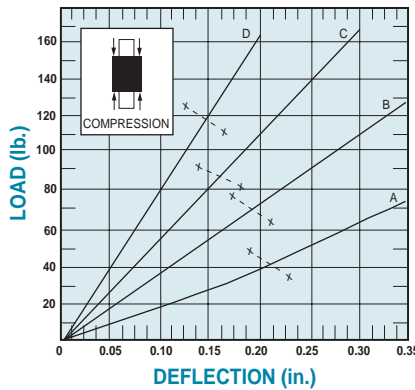

Compression		Forcing Frequency in Cycles per Minute									
Catalog Number	Maximum Load lb. (kgf)	600	850	950	1100	1250	1500	1750	2000	2500	3000
		Minimum Load for 81% Isolation lb. (kgf)									
V10Z 2-310A	41 (18.6)	—	—	—	34.5 (15.6)	27.5 (12.5)	19.0 (8.6)	14.0 (6.4)	10.0 (4.5)	7.0 (3.2)	—
V10Z 2-310B	64 (29)	—	—	—	—	48.0 (21.8)	32.0 (14.5)	24.0 (10.9)	17.5 (7.9)	12.0 (5.4)	8.5 (3.9)
V10Z 2-310C	90 (40.8)	—	—	—	—	80.0 (36.3)	55.0 (24.9)	41.5 (18.8)	30.0 (13.6)	20.0 (9.1)	14.0 (6.4)
V10Z 2-310D	120 (54.4)	—	—	—	—	—	89.0 (40.4)	70.5 (32)	53.0 (24)	38.5 (17.5)	26.5 (12)

Shear		Forcing Frequency in Cycles per Minute									
Catalog Number	Maximum Load lb. (kgf)	600	850	950	1100	1250	1500	1750	2000	2500	3000
		Minimum Load for 81% Isolation lb. (kgf)									
V10Z 2-310A	21 (9.5)	20.0 (9.1)	11.0 (5)	8.5 (3.9)	6.7 (3)	5.5 (2.5)	*	*	*	*	*
V10Z 2-310B	31 (14.1)	—	18.0 (8.2)	14.0 (6.4)	10.5 (4.8)	8.0 (3.6)	5.5 (2.5)	*	*	*	*
V10Z 2-310C	48 (21.8)	—	31.5 (14.3)	25.0 (11.3)	19.5 (8.8)	15.5 (7)	11.0 (5)	8.5 (3.9)	*	*	*
V10Z 2-310D	63 (28.6)	—	50.0 (22.7)	41.0 (18.6)	32.6 (14.8)	27.5 (12.5)	20.5 (9.3)	16.0 (7.3)	14.0 (6.4)	8.0 (3.6)	*

*At these forcing frequencies, lesser loads will yield less than 81% isolation.



Cylindrical Mounts – To 123 lbs.

www.vibrationmounts.com Phone: 516.328.3662 Fax: 516.328.3365

- MATERIAL: Fasteners – Steel, Zinc Plated
Isolator – Natural Rubber

- FOR COMPRESSION LOADS OF 56 TO 123 POUNDS (25.4 TO 55.8 kgf)
- FOR SHEAR LOADS OF 32 TO 63 POUNDS (14.5 TO 28.6 kgf)

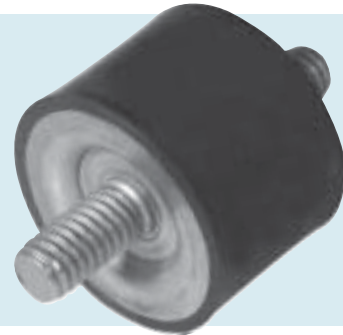
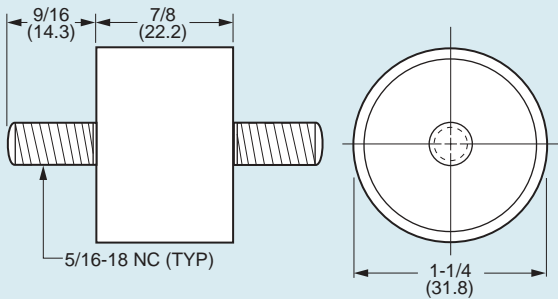

NOTE: Dimensions in () are mm.

LOAD DEFLECTION GRAPHS
Deflections below the line x-x are considered safe practice for static loads; data above that line are useful for calculating deflections under dynamic loads.

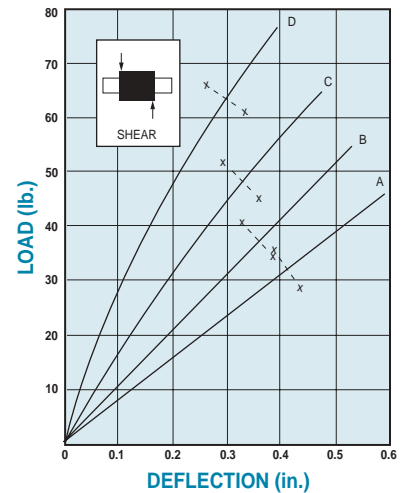
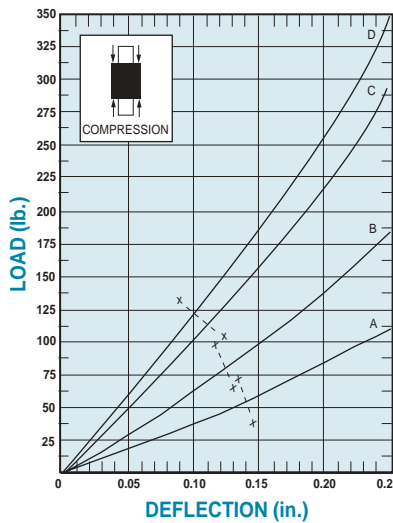

Compression		Forcing Frequency in Cycles per Minute									
Catalog Number	Maximum Load lb. (kgf)	750	850	950	1100	1250	1500	1750	2000	2500	3000
		Minimum Load for 81% Isolation lb. (kgf)									
V10Z 2-315A	56 (25.4)	—	—	—	—	—	40.0 (18.1)	28.0 (12.7)	21.0 (9.5)	13.0 (5.9)	—
V10Z 2-315B	82 (37.2)	—	—	—	—	—	68.5 (31.1)	50.0 (22.7)	35.0 (15.9)	23.0 (10.4)	17.0 (7.7)
V10Z 2-315C	115 (52.2)	—	—	—	—	—	107.0 (48.5)	77.5 (35.2)	57.0 (25.9)	27.5 (12.5)	22.0 (10)
V10Z 2-315D	123 (55.8)	—	—	—	—	—	—	92.0 (41.7)	67.5 (30.6)	43.0 (19.5)	32.0 (14.5)

Shear		Forcing Frequency in Cycles per Minute									
Catalog Number	Maximum Load lb. (kgf)	750	850	950	1100	1250	1500	1750	2000	2500	3000
		Minimum Load for 81% Isolation lb. (kgf)									
V10Z 2-315A	32 (14.5)	31.0 (14.1)	24.0 (10.9)	19.0 (8.6)	14.0 (6.4)	11.0 (5)	8.0 (3.6)	5.6 (2.5)	*	*	*
V10Z 2-315B	37 (16.8)	—	32.0 (14.5)	26.0 (11.8)	19.0 (8.6)	15.0 (6.8)	10.0 (4.5)	7.6 (3.4)	5.1 (2.3)	*	*
V10Z 2-315C	48 (21.8)	—	45.0 (20.4)	38.0 (17.2)	29.0 (13.2)	24.0 (10.9)	17.0 (7.7)	13.0 (5.9)	10.0 (4.5)	6.5 (2.9)	*
V10Z 2-315D	63 (28.6)	—	—	56.0 (25.4)	45.0 (20.4)	38.0 (17.2)	27.0 (12.2)	21.0 (9.5)	17.0 (7.7)	11.0 (5)	8.0 (3.6)

*At these forcing frequencies, lesser loads will yield less than 81% isolation.



Cylindrical Mounts – To 142 lbs.

www.vibrationmounts.com Phone: 516.328.3662 Fax: 516.328.3365

- MATERIAL: Fasteners – Steel, Zinc Plated
Isolator – Natural Rubber

- FOR COMPRESSION LOADS OF 56 TO 142 POUNDS (25.4 TO 64.4 kgf)
- FOR SHEAR LOADS OF 32 TO 64 POUNDS (14.5 TO 29 kgf)

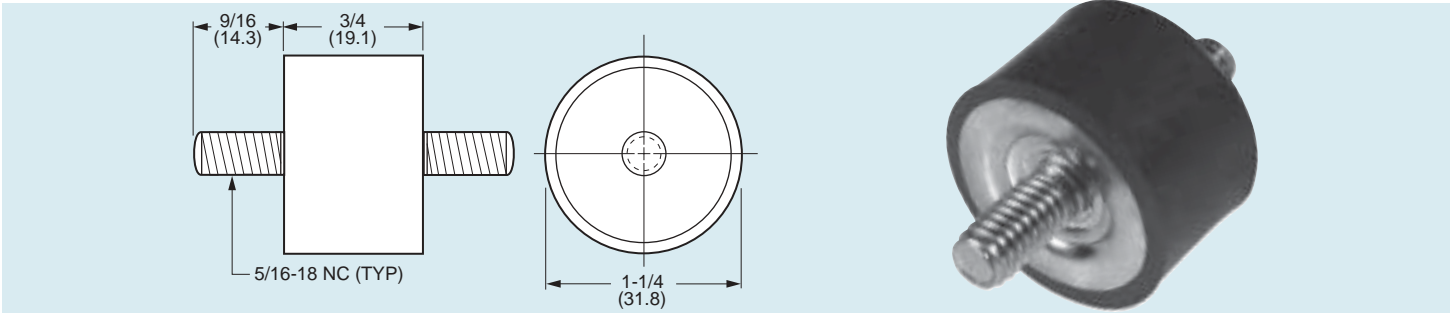

NOTE: Dimensions in () are mm.

LOAD DEFLECTION GRAPHS

Deflections below the line x-x are considered safe practice for static loads; data above that line are useful for calculating deflections under dynamic loads.

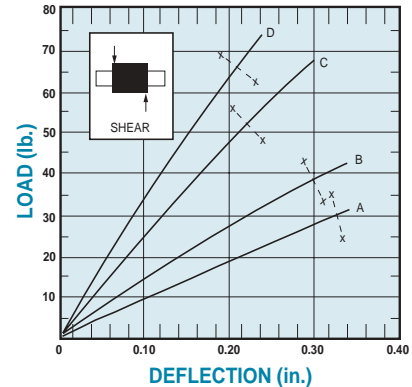
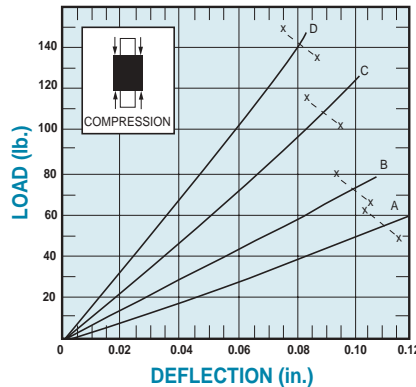

Compression		Forcing Frequency in Cycles per Minute									
Catalog Number	Maximum Load lb. (kgf)	950	1100	1250	1500	1750	2000	2250	2500	3000	3600
		Minimum Load for 81% Isolation lb. (kgf)									
V10Z 2-314A	56 (24.4)	—	—	—	50.0 (22.7)	38.0 (17.2)	28.5 (12.9)	22.5 (10.2)	18.0 (8.2)	12.5 (5.7)	—
V10Z 2-314B	73 (33.1)	—	—	—	73.0 (33.1)	51.0 (23.1)	39.0 (17.7)	30.5 (13.8)	24.5 (11.1)	16.5 (7.5)	12.0 (5.4)
V10Z 2-314C	109 (49.5)	—	—	—	—	85.0 (38.6)	63.5 (28.8)	50.0 (22.7)	41.0 (18.6)	28.0 (12.7)	20.0 (9.1)
V10Z 2-314D	142 (64.4)	—	—	—	—	129.0 (58.5)	99.0 (44.9)	78.0 (35.4)	64.0 (29)	44.0 (20)	30.0 (13.6)

Shear		Forcing Frequency in Cycles per Minute									
Catalog Number	Maximum Load lb. (kgf)	950	1100	1250	1500	1750	2000	2250	2500	3000	3600
		Minimum Load for 81% Isolation lb. (kgf)									
V10Z 2-314A	32 (14.5)	23.0 (10.4)	18.0 (8.2)	14.5 (6.6)	10.0 (4.5)	7.5 (3.4)	*	*	*	*	*
V10Z 2-314B	38 (17.2)	32.0 (14.5)	24.5 (11.1)	19.0 (8.6)	13.0 (5.9)	9.5 (4.3)	7.0 (3.2)	*	*	*	*
V10Z 2-314C	51 (23.1)	—	44.5 (20.2)	36.0 (16.3)	26.0 (11.8)	19.5 (8.8)	14.0 (6.4)	12.0 (5.4)	10.0 (4.5)	*	*
V10Z 2-314D	64 (29)	—	58.0 (26.3)	46.5 (21.1)	34.0 (15.4)	27.0 (12.2)	20.5 (9.3)	17.0 (7.7)	14.0 (6.4)	9.5 (4.3)	*

*At these forcing frequencies, lesser loads will yield less than 81% isolation.



Cylindrical Mounts – To 185 lbs.

www.vibrationmounts.com Phone: 516.328.3662 Fax: 516.328.3365

- **MATERIAL:** Fasteners – Steel, Zinc Plated
Isolator – Natural Rubber

- **FOR COMPRESSION LOADS OF 93 TO 185 POUNDS (42.2 TO 83.9 kgf)**
- **FOR SHEAR LOADS OF 36 TO 67 POUNDS (16.3 TO 30.4 kgf)**

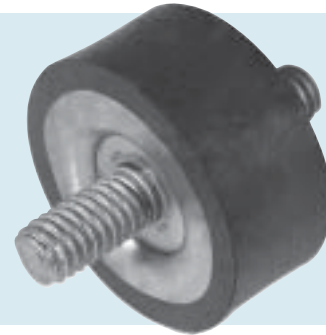
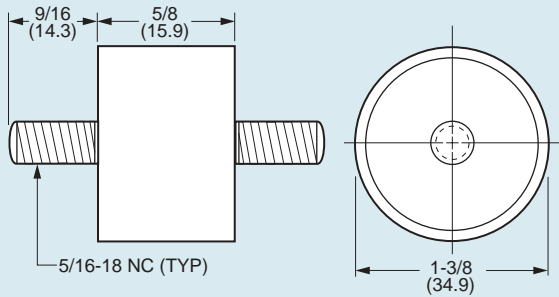

NOTE: Dimensions in () are mm.

LOAD DEFLECTION GRAPHS
Deflections below the line x-x are considered safe practice for static loads; data above that line are useful for calculating deflections under dynamic loads.

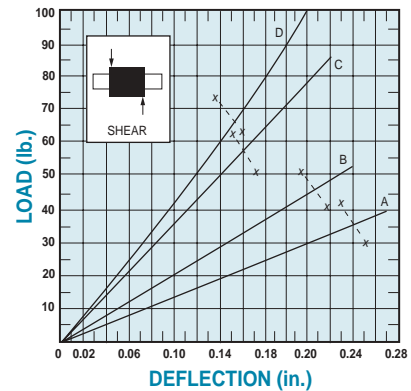
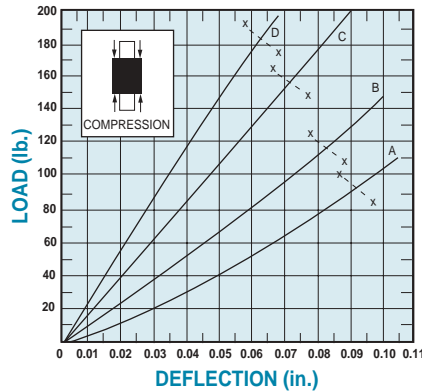

Compression		Forcing Frequency in Cycles per Minute									
Catalog Number	Maximum Load lb. (kgf)	950	1100	1250	1500	1750	2000	2250	2500	2750	3000
		Minimum Load for 81% Isolation lb. (kgf)									
V10Z 2-312A	93 (42.2)	—	—	—	—	71.0 (32.2)	51.0 (23.1)	39.0 (17.7)	31.0 (14.1)	25.0 (11.3)	—
V10Z 2-312B	118 (53.5)	—	—	—	—	106.0 (48.1)	81.0 (36.7)	64.0 (29)	52.0 (23.6)	43.0 (19.5)	35.0 (15.9)
V10Z 2-312C	158 (71.7)	—	—	—	—	—	121.0 (54.9)	96.0 (43.5)	79.0 (35.8)	65.0 (29.5)	54.0 (24.5)
V10Z 2-312D	185 (83.9)	—	—	—	—	—	164.0 (74.4)	131.0 (59.4)	109.0 (49.4)	90.0 (40.8)	74.0 (33.6)

Shear		Forcing Frequency in Cycles per Minute									
Catalog Number	Maximum Load lb. (kgf)	950	1100	1250	1500	1750	2000	2250	2500	2750	3000
		Minimum Load for 81% Isolation lb. (kgf)									
V10Z 2-312A	36 (16.3)	34.0 (15.4)	25.0 (11.3)	19.0 (8.6)	13.5 (6.1)	10.0 (4.5)	*	*	*	*	*
V10Z 2-312B	46 (20.9)	—	38.0 (17.2)	30.0 (13.6)	21.0 (9.5)	16.0 (7.3)	12.0 (5.4)	9.5 (4.3)	*	*	*
V10Z 2-312C	57 (25.9)	—	—	50.0 (22.7)	35.0 (15.9)	26.0 (11.8)	20.0 (9.1)	16.0 (7.3)	13.0 (5.9)	*	*
V10Z 2-312D	67 (30.4)	—	—	66.0 (29.9)	46.0 (20.9)	34.0 (15.4)	26.0 (11.8)	21.0 (9.5)	18.0 (8.2)	14.0 (6.4)	*

*At these forcing frequencies, lesser loads will yield less than 81% isolation.



Cylindrical Mounts – To 330 lbs.

www.vibrationmounts.com Phone: 516.328.3662 Fax: 516.328.3365

- **MATERIAL:** Fasteners – Steel, Zinc Plated
Isolator – Natural Rubber

- **FOR COMPRESSION LOADS TO 330 POUNDS (149.7 kgf)**
- **FOR SHEAR LOADS TO 140 POUNDS (63.5 kgf)**

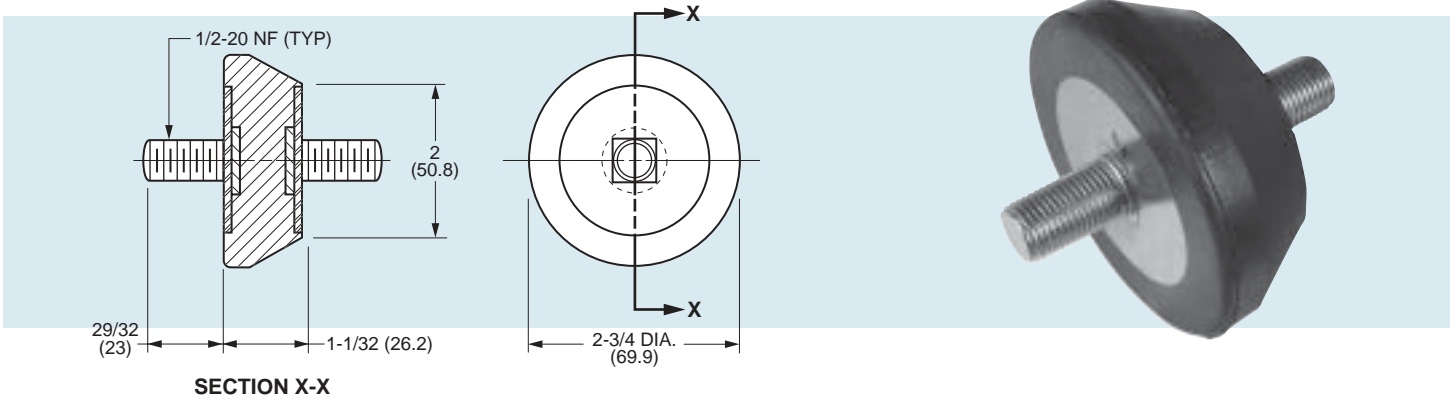

NOTE: Dimensions in () are mm.

LOAD DEFLECTION GRAPHS

Deflections below the line x--x are considered safe practice for static loads; data above that line are useful for calculating deflections under dynamic loads.

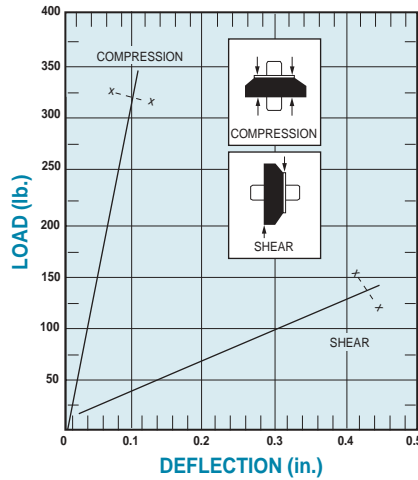

Catalog Number	Mode	Maximum Load lb. (kgf)	Forcing Frequency in Cycles per Minute								
			700	850	1100	1250	1500	1750	2000	2250	2500
			Minimum Load for 81% Isolation lb. (kgf)								
V10Z 2-330B	Compression	330 (149.7)	—	—	—	—	255 (115.7)	190 (86.2)	150 (68)	120 (54.4)	90 (40.8)
	Shear	140 (63.5)	140 (63.5)	105 (47.6)	65 (29.5)	52 (23.6)	38 (17.2)	32 (14.5)	*	*	*

*At these forcing frequencies, lesser loads will yield less than 81% isolation.



Cylindrical Mounts – To 6 kgf

www.vibrationmounts.com Phone: 516.328.3662 Fax: 516.328.3365

SECTION I

- **MATERIAL:** Fastener – Steel, Zinc Plated
Isolator – Natural Rubber

- **FOR COMPRESSION LOADS OF 2 TO 6 kgf (4.9 TO 13.3 lb.)**
- **FOR SHEAR LOADS OF 1 TO 3 kgf (2.7 TO 6.4 lb.)**

New

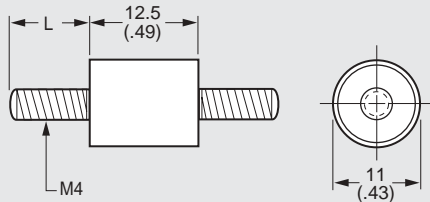

NOTE: Dimensions in () are inch.

Metric

NOTE: Maximum unthreaded portion of stud does not exceed 1.59 mm (.06 in.).

LOAD DEFLECTION GRAPHS
Deflections below the line x-x are considered safe practice for static loads; data above that line are useful for calculating deflections under dynamic loads.

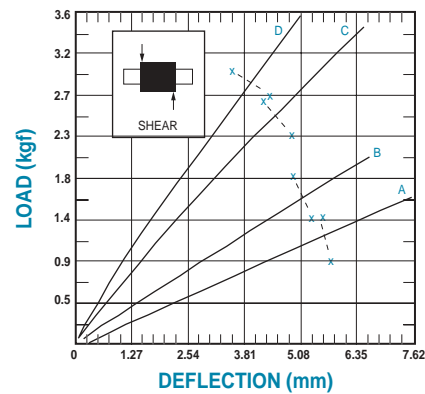
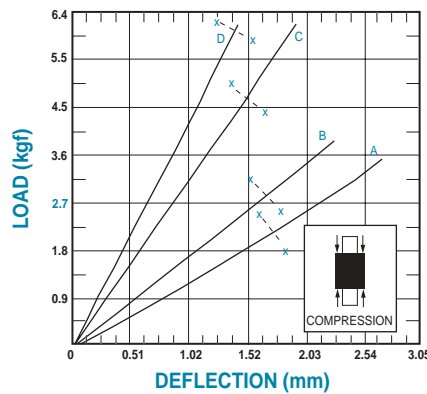

Compression		Forcing Frequency in Cycles per Minute									
Catalog Number	Maximum Load kgf (lb.)	1000	1250	1500	1750	2000	2250	2500	2750	3000	3600
		Minimum Load for 81% Isolation kgf (lb.)									
V10Z 2M302AM4□□	2.2 (4.9)	—	—	—	—	1.8 (3.9)	1.4 (3.0)	1.1 (2.4)	0.9 (2.0)	0.8 (1.8)	0.5 (1.0)
V10Z 2M302BM4□□	2.9 (6.4)	—	—	—	—	2.4 (5.3)	1.9 (4.2)	1.5 (3.4)	1.3 (2.9)	1.1 (2.5)	0.7 (1.5)
V10Z 2M302CM4□□	4.7 (10.4)	—	—	—	—	4.5 (9.8)	3.5 (7.7)	2.9 (6.3)	2.4 (5.2)	2 (4.3)	1.2 (2.6)
V10Z 2M302DM4□□	6 (13.3)	—	—	—	—	5.9 (13.1)	4.7 (10.4)	3.9 (8.5)	3.2 (7.0)	2.6 (5.8)	1.9 (4.2)

Shear		Forcing Frequency in Cycles per Minute									
Catalog Number	Maximum Load kgf (lb.)	1000	1250	1500	1750	2000	2250	2500	2750	3000	3600
		Minimum Load for 81% Isolation kgf (lb.)									
V10Z 2M302AM4□□	1.2 (2.7)	1.18 (2.6)	0.77 (1.7)	0.54 (1.2)	0.45 (1.0)	0.32 (.7)	0.22 (.5)	*	*	*	*
V10Z 2M302BM4□□	1.6 (3.6)	—	1.18 (2.6)	0.87 (1.9)	0.63 (1.4)	0.5 (1.1)	0.37 (.8)	0.32 (.7)	0.28 (.6)	*	*
V10Z 2M302CM4□□	2.5 (5.6)	—	2.14 (4.7)	1.45 (3.2)	1.13 (2.5)	0.87 (1.9)	0.68 (1.5)	0.59 (1.3)	0.5 (1.1)	2 (.9)	0.32 (.7)
V10Z 2M302DM4□□	2.9 (6.4)	—	2.76 (6.1)	2 (4.4)	1.54 (3.4)	1.22 (2.7)	1 (2.2)	0.82 (1.8)	0.72 (1.6)	2.6 (1.4)	0.45 (1.0)

Length, L
07 = 7 mm (.275)
10 = 10mm (.394)

*At these forcing frequencies, lesser loads will yield less than 81% isolation.



Cylindrical Mounts – To 34 kgf

www.vibrationmounts.com Phone: 516.328.3662 Fax: 516.328.3365

SECTION I

- **MATERIAL:** Fastener – Steel, Zinc Plated
Isolator – Natural Rubber

- **FOR COMPRESSION LOADS OF 18 TO 34 kgf (40 TO 75 lb.)**
- **FOR SHEAR LOADS OF 9 TO 18 kgf (19 TO 42 lb.)**

New

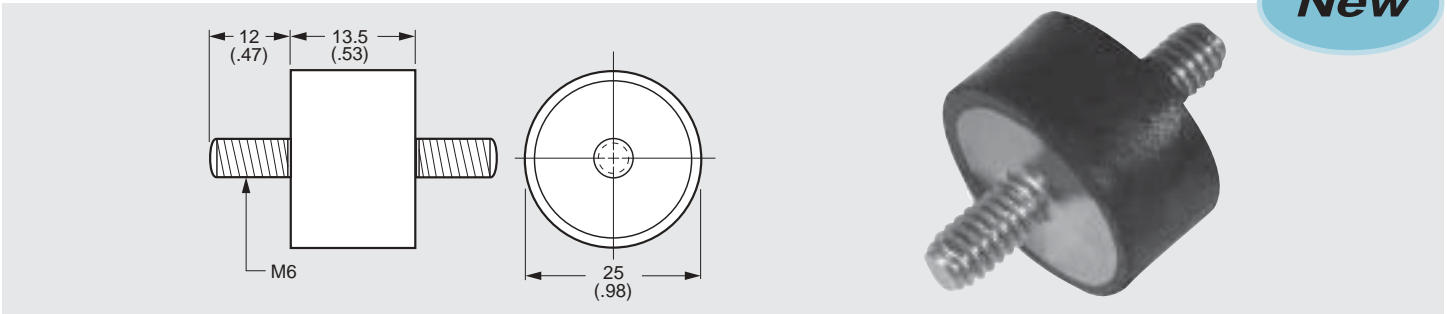

NOTE: Dimensions in () are inch.

Metric

NOTE: Maximum unthreaded portion of stud does not exceed 1.59 mm (.06 in.).

LOAD DEFLECTION GRAPHS
Deflections below the line x-x are considered safe practice for static loads; data above that line are useful for calculating deflections under dynamic loads.

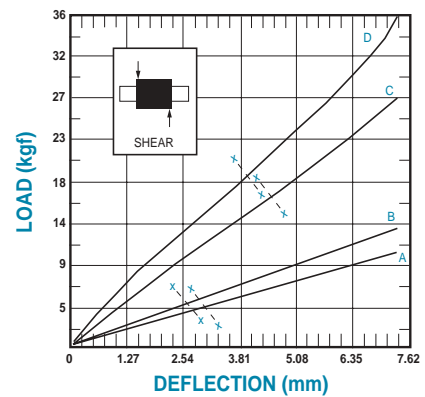
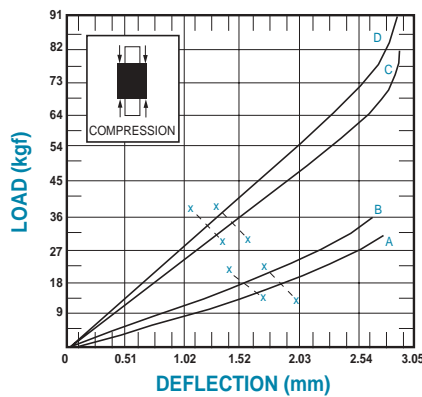

Compression		Forcing Frequency in Cycles per Minute									
Catalog Number	Maximum Load kgf (lb.)	1100	1250	1500	1750	2000	2250	2500	2750	3000	3600
		Minimum Load for 81% Isolation kgf (lb.)									
V10Z 2M305AM06	18.2 (40.1)	—	—	—	—	13.8 (30.4)	10.9 (24.0)	8.8 (19.4)	4.8 (10.6)	3.2 (7.1)	2.3 (5.1)
V10Z 2M305BM06	19.5 (43.0)	—	—	—	—	17.2 (37.9)	13.6 (30.0)	11.3 (24.9)	6.4 (14.1)	4.3 (9.5)	3.2 (7.1)
V10Z 2M305CM06	33.6 (74.1)	—	—	—	—	33.6 (74.1)	26.5 (58.4)	21.6 (47.6)	10.9 (24.0)	7.7 (17.0)	5.2 (11.5)
V10Z 2M305DM06	34 (75.0)	—	—	—	—	—	30.6 (67.5)	25.2 (55.6)	16.3 (35.9)	11.1 (24.5)	7.7 (17.0)

Shear		Forcing Frequency in Cycles per Minute									
Catalog Number	Maximum Load kgf (lb.)	1100	1250	1500	1750	2000	2250	2500	2750	3000	3600
		Minimum Load for 81% Isolation kgf (lb.)									
V10Z 2M305AM06	8.6 (19.0)	7.1 (15.7)	5.7 (12.6)	3.8 (8.4)	2.9 (6.4)	*	*	*	1 (2.2)	1 (2.2)	*
V10Z 2M305BM06	9.5 (20.9)	8.6 (19.0)	7 (15.4)	4.8 (10.6)	3.6 (7.9)	2.9 (6.4)	2.3 (5.1)	*	1.2 (2.6)	1 (2.2)	*
V10Z 2M305CM06	16.8 (37.0)	—	14.3 (31.5)	10.2 (22.5)	7.7 (17.0)	6.4 (14.1)	5.2 (11.5)	4.3 (9.5)	2.8 (6.2)	2 (4.4)	1.6 (3.5)
V10Z 2M305DM06	19 (41.9)	—	18.1 (40.0)	13.3 (29.3)	10 (22.0)	8.4 (18.5)	7.2 (15.9)	5.9 (13.0)	3.8 (8.4)	3 (6.0)	2.3 (5.1)

*At these forcing frequencies, lesser loads will yield less than 81% isolation.



Cylindrical Mounts – To 36 kgf

www.vibrationmounts.com Phone: 516.328.3662 Fax: 516.328.3365

- **MATERIAL:** Fastener – Steel, Zinc Plated
Isolator – Natural Rubber

- **FOR COMPRESSION LOADS OF 15 TO 36 kgf (33 TO 79 lb.)**
- **FOR SHEAR LOADS OF 8 TO 18 kgf (18 TO 40 lb.)**

New

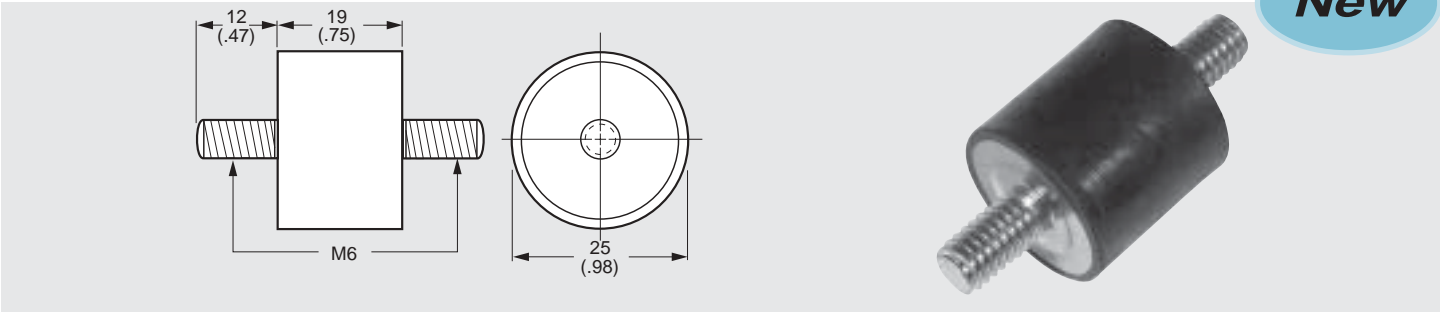

NOTE: Dimensions in () are inch.

Metric

NOTE: Maximum unthreaded portion of stud does not exceed 1.59 mm (.06 in.).

LOAD DEFLECTION GRAPHS
Deflections below the line x-x are considered safe practice for static loads; data above that line are useful for calculating deflections under dynamic loads.

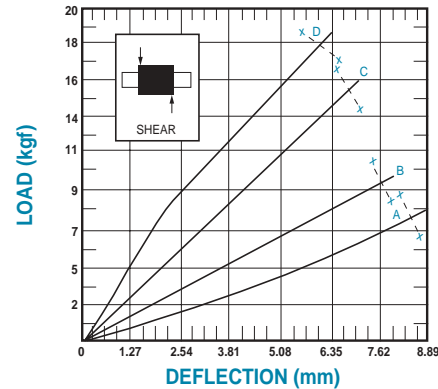
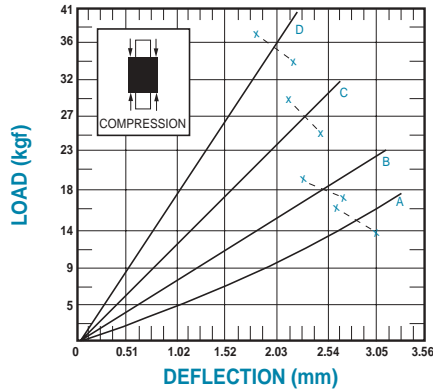

Compression		Forcing Frequency in Cycles per Minute									
Catalog Number	Maximum Load kgf (lb.)	1000	1250	1500	1750	2000	2250	2500	2750	3000	3600
		Minimum Load for 81% Isolation kgf (lb.)									
V10Z 2M300AM06	15 (33)	—	—	—	13.2 (29)	9.5 (21)	7.3 (16)	5.7 (12.5)	4.8 (10.5)	3.2 (7.0)	2.3 (5.0)
V10Z 2M300BM06	18.1 (40)	—	—	—	17.9 (39.5)	12.9 (28.5)	9.8 (21.5)	7.7 (17.0)	6.4 (14.0)	4.3 (9.5)	3.2 (7.0)
V10Z 2M300CM06	27.2 (60)	—	—	—	—	22.2 (49)	16.8 (37)	13.4 (29.5)	10.9 (24.0)	7.7 (17.0)	5.2 (11.5)
V10Z 2M300DM06	35.9 (79)	—	—	—	—	32.9 (72.5)	25 (55)	19.7 (43.5)	16.3 (36)	11.1 (24.5)	7.7 (17.0)

Shear		Forcing Frequency in Cycles per Minute									
Catalog Number	Maximum Load kgf (lb.)	1000	1250	1500	1750	2000	2250	2500	2750	3000	3600
		Minimum Load for 81% Isolation kgf (lb.)									
V10Z 2M300AM06	8.2 (18)	7.3 (16.0)	4.2 (9.3)	3.3 (7.2)	2.3 (5.0)	1.7 (3.8)	1.3 (2.8)	1 (2.3)	0.8 (1.8)	0.5 (1.2)	*
V10Z 2M300BM06	9.5 (21)	—	5.9 (13.0)	4.6 (10.2)	3.2 (7.0)	2.3 (5.3)	1.8 (4.0)	1.4 (3.2)	1.2 (2.6)	0.8 (1.8)	*
V10Z 2M300CM06	15.4 (34)	—	11.1 (24.5)	9.1 (20)	6.7 (14.7)	5.1 (11.2)	4.1 (9.0)	3.4 (7.5)	2.8 (6.2)	2 (4.5)	1.6 (3.5)
V10Z 2M300DM06	18.1 (40)	—	14.5 (32)	11.8 (26)	8.6 (19.0)	6.7 (14.8)	5.5 (12.0)	4.5 (10.0)	3.8 (8.3)	2.7 (6.0)	2.3 (5.0)

*At these forcing frequencies, lesser loads will yield less than 81% isolation.



Cylindrical Mounts – To 48 kgf

www.vibrationmounts.com Phone: 516.328.3662 Fax: 516.328.3365

● MATERIAL: Fasteners – Steel, Zinc Plated
Isolator – Natural Rubber

● FOR COMPRESSION LOADS OF 21 TO 48 kgf (47 TO 105 lb.)
● FOR SHEAR LOADS OF 12 TO 30 kgf (27 TO 66 lb.)

New

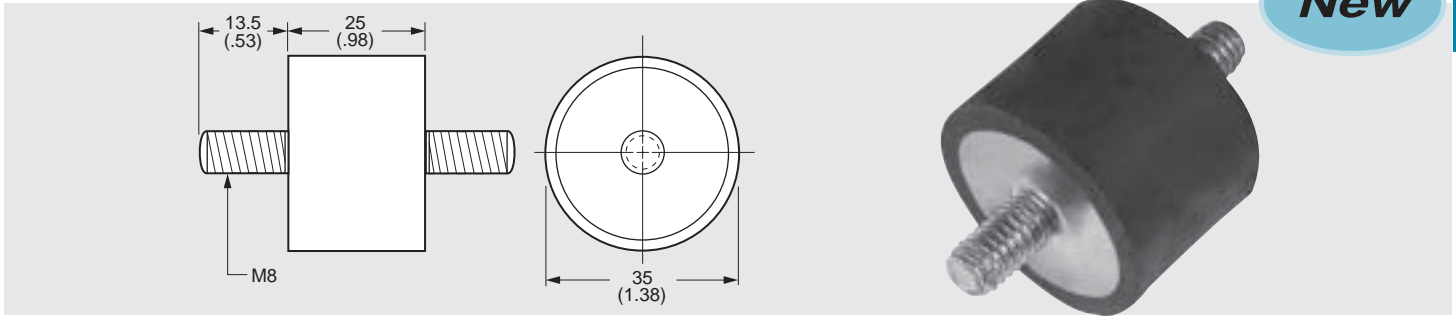

NOTE: Dimensions in () are inch.

Metric

LOAD DEFLECTION GRAPHS
Deflections below the line x-x are considered safe practice for static loads; data above that line are useful for calculating deflections under dynamic loads.

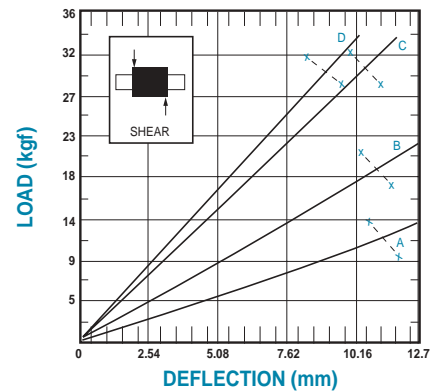
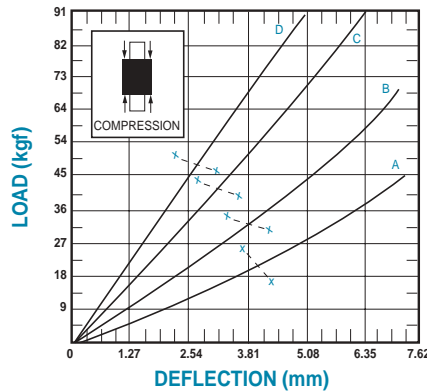

Compression		Forcing Frequency in Cycles per Minute									
Catalog Number	Maximum Load kgf (lb.)	700	850	1100	1250	1500	1750	2000	2250	2500	3000
		Minimum Load for 81% Isolation kgf (lb.)									
V10Z 2M311AM08	21.3 (47)	—	—	—	20.2 (44.5)	13.6 (30)	10 (22)	8.2 (18)	6.1 (13.5)	5 (11)	—
V10Z 2M311BM08	33.6 (74)	—	—	—	32.9 (72.5)	22 (48.5)	16.1 (35.5)	12.3 (27)	9.5 (21)	7.9 (17.5)	5.7 (12.5)
V10Z 2M311CM08	43.5 (96)	—	—	—	—	34.3 (75.7)	25.5 (55.5)	19.5 (43)	15.4 (34)	12.7 (28)	8.8 (19.5)
V10Z 2M311DM08	47.6 (105)	—	—	—	—	45.4 (100)	33.1 (73)	25.6 (56.5)	20.4 (45)	17.2 (38)	11.6 (25.5)

Shear		Forcing Frequency in Cycles per Minute									
Catalog Number	Maximum Load kgf (lb.)	700	850	1100	1250	1500	1750	2000	2250	2500	3000
		Minimum Load for 81% Isolation kgf (lb.)									
V10Z 2M311AM08	12.3 (27)	12.3 (27)	8.8 (19.5)	5.2 (11.5)	4.1 (9)	2.7 (6)	*	*	*	*	*
V10Z 2M311BM08	18.6 (41)	—	14.1 (31)	8.6 (19)	6.6 (14.5)	4.8 (10.5)	3.6 (8)	*	*	*	*
V10Z 2M311CM08	29.9 (66)	—	24.3 (53.5)	15 (33)	12 (26.5)	8.6 (19)	6.4 (14)	5.2 (11.5)	4.1 (9)	*	*
V10Z 2M311DM08	29.9 (66)	—	27.7 (61)	17.2 (38)	13.8 (30.5)	10 (22)	8.8 (19.5)	5.9 (13)	4.8 (10.5)	3.9 (8.5)	*

*At these forcing frequencies, lesser loads will yield less than 81% isolation.



Cylindrical Mounts – To 54 kgf

www.vibrationmounts.com Phone: 516.328.3662 Fax: 516.328.3365

• **MATERIAL:** Fasteners – Steel, Zinc Plated
Isolator – Natural Rubber

• **FOR COMPRESSION LOADS OF 19 TO 54 kgf (41 TO 120 lb.)**
• **FOR SHEAR LOADS OF 10 TO 29 kgf (21 TO 63 lb.)**

New

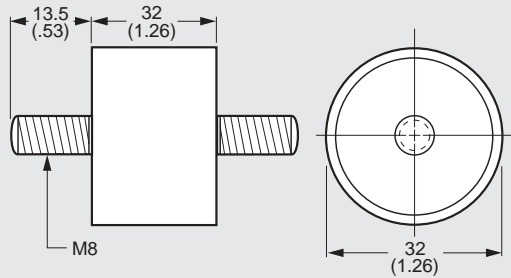

Metric

NOTE: Dimensions in () are inch.

LOAD DEFLECTION GRAPHS
Deflections below the line x-x are considered safe practice for static loads; data above that line are useful for calculating deflections under dynamic loads.

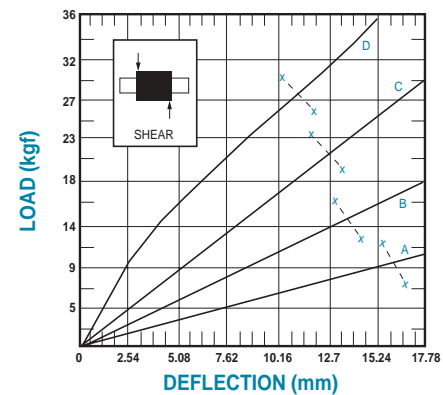
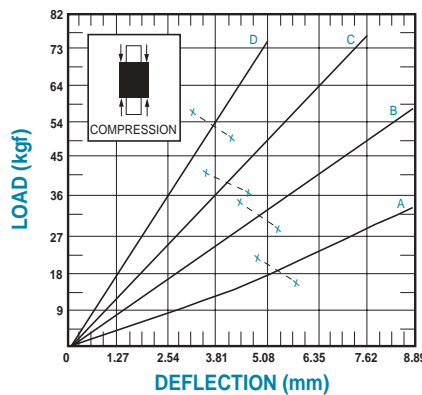

Compression		Forcing Frequency in Cycles per Minute									
Catalog Number	Maximum Load kgf (lb.)	600	850	950	1100	1250	1500	1750	2000	2500	3000
		Minimum Load for 81% Isolation kgf (lb.)									
V10Z 2M310AM08	18.6 (41)	—	—	—	15.7 (34.5)	12.5 (27.5)	8.6 (19)	6.4 (14)	4.5 (10)	3.2 (7)	—
V10Z 2M310BM08	29 (64)	—	—	—	—	21.8 (48)	14.5 (32)	10.9 (24)	7.9 (17.5)	5.5 (12)	3.9 (8.5)
V10Z 2M310CM08	40.8 (90)	—	—	—	—	36.3 (80)	25 (55)	18.8 (41.5)	13.6 (30)	9.1 (20)	6.4 (14)
V10Z 2M310DM08	54.4 (120)	—	—	—	—	—	40.4 (89)	32 (70.5)	24 (53)	17.5 (38.5)	12 (26.5)

Shear		Forcing Frequency in Cycles per Minute									
Catalog Number	Maximum Load kgf (lb.)	600	850	950	1100	1250	1500	1750	2000	2500	3000
		Minimum Load for 81% Isolation kgf (lb.)									
V10Z 2M310AM08	9.5 (21)	9.1 (20)	5 (11)	3.9 (8.5)	3 (6.7)	2.5 (5.5)	*	*	*	*	*
V10Z 2M310BM08	14.1 (31)	—	8.2 (18)	6.4 (14)	4.8 (10.5)	3.6 (8)	2.5 (5.5)	*	*	*	*
V10Z 2M310CM08	21.8 (48)	—	14.3 (31.5)	11.3 (25)	8.8 (19.5)	7 (15.5)	5 (11)	3.9 (8.5)	*	*	*
V10Z 2M310DM08	28.6 (63)	—	22.7 (50)	18.6 (41)	14.8 (32.6)	12.5 (27.5)	9.3 (20.5)	7.3 (16)	6.4 (14)	3.6 (8)	*

*At these forcing frequencies, lesser loads will yield less than 81% isolation.



Cylindrical Mounts – To 64 kgf

www.vibrationmounts.com Phone: 516.328.3662 Fax: 516.328.3365

- **MATERIAL:** Fasteners – Steel, Zinc Plated
Isolator – Natural Rubber

- **FOR COMPRESSION LOADS OF 25 TO 64 kgf (56 TO 142 lb.)**
- **FOR SHEAR LOADS OF 15 TO 29 kgf (32 TO 64 lb.)**

New

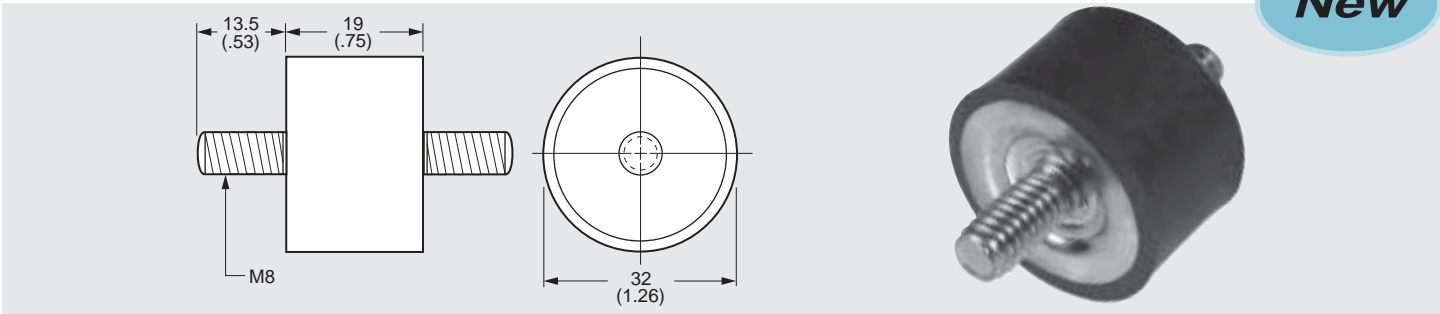

NOTE: Dimensions in () are inch.

Metric

LOAD DEFLECTION GRAPHS
Deflections below the line x-x are considered safe practice for static loads; data above that line are useful for calculating deflections under dynamic loads.

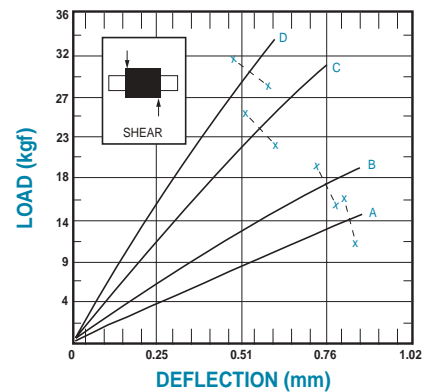
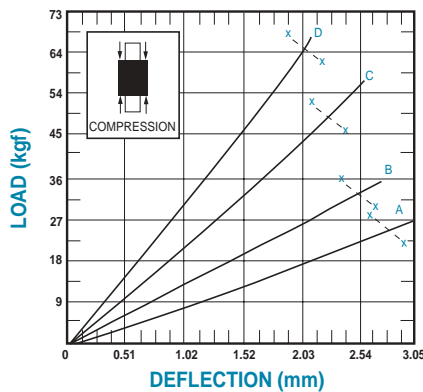

Compression		Forcing Frequency in Cycles per Minute									
Catalog Number	Maximum Load kgf (lb.)	950	1100	1250	1500	1750	2000	2250	2500	3000	3600
		Minimum Load for 81% Isolation kgf (lb.)									
V10Z 2M314AM08	25.4 (56)	—	—	—	22.7 (50)	17.2 (38)	12.9 (28.5)	10.2 (22.5)	8.2 (18)	5.7 (12.5)	—
V10Z 2M314BM08	33.1 (73)	—	—	—	33.1 (73)	23.1 (51)	17.7 (39)	13.8 (30.5)	11.1 (24.5)	7.5 (16.5)	5.5 (12)
V10Z 2M314CM08	49.5 (109)	—	—	—	—	38.6 (85)	28.8 (63.5)	22.7 (50)	18.6 (41)	12.7 (28)	9.1 (20)
V10Z 2M314DM08	64.4 (142)	—	—	—	—	58.5 (129)	44.9 (99)	35.4 (78)	29 (64)	20 (44)	13.6 (30)

Shear		Forcing Frequency in Cycles per Minute									
Catalog Number	Maximum Load kgf (lb.)	950	1100	1250	1500	1750	2000	2250	2500	3000	3600
		Minimum Load for 81% Isolation kgf (lb.)									
V10Z 2M314AM08	14.5 (32)	10.4 (23)	8.2 (18)	6.6 (14.5)	4.5 (10)	3.4 (7.5)	*	*	*	*	*
V10Z 2M314BM08	17.2 (38)	14.5 (32)	11.1 (24.5)	8.6 (19)	5.9 (13)	4.3 (9.5)	3.2 (7)	*	*	*	*
V10Z 2M314CM08	23.1 (51)	—	20.2 (44.5)	16.3 (36)	11.8 (26)	8.8 (19.5)	6.4 (14)	5.5 (12)	4.5 (10)	*	*
V10Z 2M314DM08	29 (64)	—	26.3 (58)	21.1 (46.5)	15.4 (34)	12.3 (27)	9.3 (20.5)	7.7 (17)	6.4 (14)	4.3 (9.5)	*

*At these forcing frequencies, lesser loads will yield less than 81% isolation.



Cylindrical Mounts – To 84 kgf

www.vibrationmounts.com Phone: 516.328.3662 Fax: 516.328.3365

- **MATERIAL:** Fasteners – Steel, Zinc Plated
Isolator – Natural Rubber

- **FOR COMPRESSION LOADS OF 42 TO 84 kgf (93 TO 185 lb.)**
- **FOR SHEAR LOADS OF 16 TO 30 kgf (36 TO 67 lb.)**

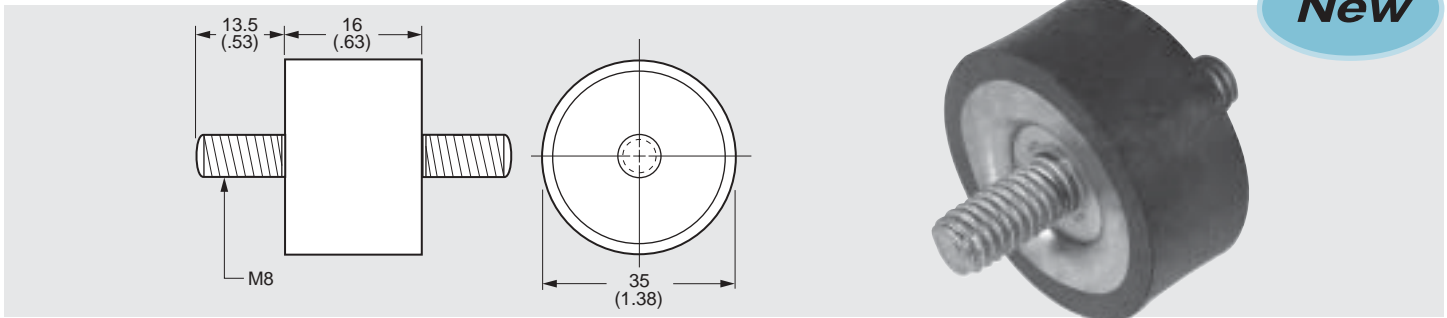

NOTE: Dimensions in () are inch.

Metric

LOAD DEFLECTION GRAPHS
Deflections below the line x-x are considered safe practice for static loads; data above that line are useful for calculating deflections under dynamic loads.

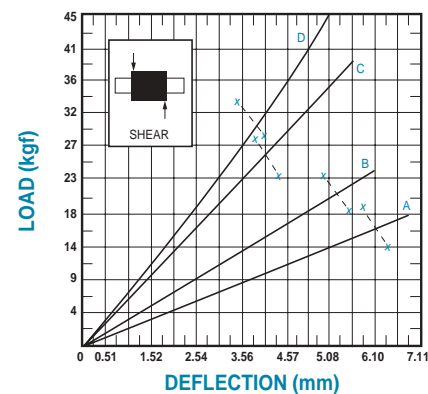
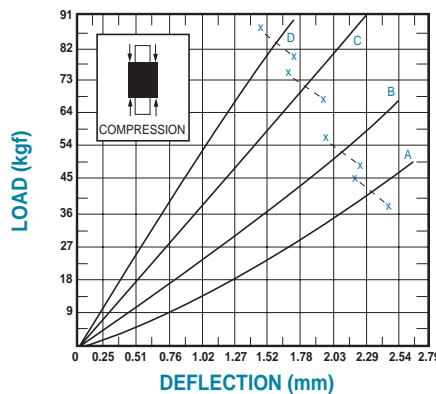

Compression		Forcing Frequency in Cycles per Minute									
Catalog Number	Maximum Load kgf (lb.)	950	1100	1250	1500	1750	2000	2250	2500	2750	3000
		Minimum Load for 81% Isolation kgf (lb.)									
V10Z 2M312AM08	42.2 (93)	—	—	—	—	32.2 (71)	23.1 (51)	17.7 (39)	14.1 (31)	11.3 (25)	—
V10Z 2M312BM08	53.5 (118)	—	—	—	—	48.1 (106)	36.7 (81)	29 (64)	23.6 (52)	19.5 (43)	15.9 (35)
V10Z 2M312CM08	71.7 (158)	—	—	—	—	54.9 (121)	43.5 (96)	35.8 (79)	29.5 (65)	24.5 (54)	—
V10Z 2M312DM08	83.9 (185)	—	—	—	—	74.4 (164)	59.4 (131)	49.5 (109)	40.8 (90)	33.6 (74)	—

Shear		Forcing Frequency in Cycles per Minute									
Catalog Number	Maximum Load kgf (lb.)	950	1100	1250	1500	1750	2000	2250	2500	2750	3000
		Minimum Load for 81% Isolation kgf (lb.)									
V10Z 2M312AM08	16.3 (36)	15.4 (34)	11.3 (25)	8.6 (19)	6.1 (13.5)	4.5 (10)	*	*	*	*	*
V10Z 2M312BM08	20.9 (46)	—	17.2 (38)	13.6 (30)	9.5 (21)	7.3 (16)	5.5 (12)	4.3 (9.5)	*	*	*
V10Z 2M312CM08	25.9 (57)	—	—	22.7 (50)	15.9 (20)	11.8 (26)	9.1 (20)	7.3 (16)	5.9 (13)	*	*
V10Z 2M312DM08	30.4 (67)	—	—	29.9 (66)	20.9 (26)	15.4 (34)	11.8 (26)	9.5 (21)	8.2 (18)	6.4 (14)	*

*At these forcing frequencies, lesser loads will yield less than 81% isolation.